

QUICK-START GUIDE

VacuFlush® Toilet System with SailVac™ VHT 5200 Series Vacuum Holding Tank

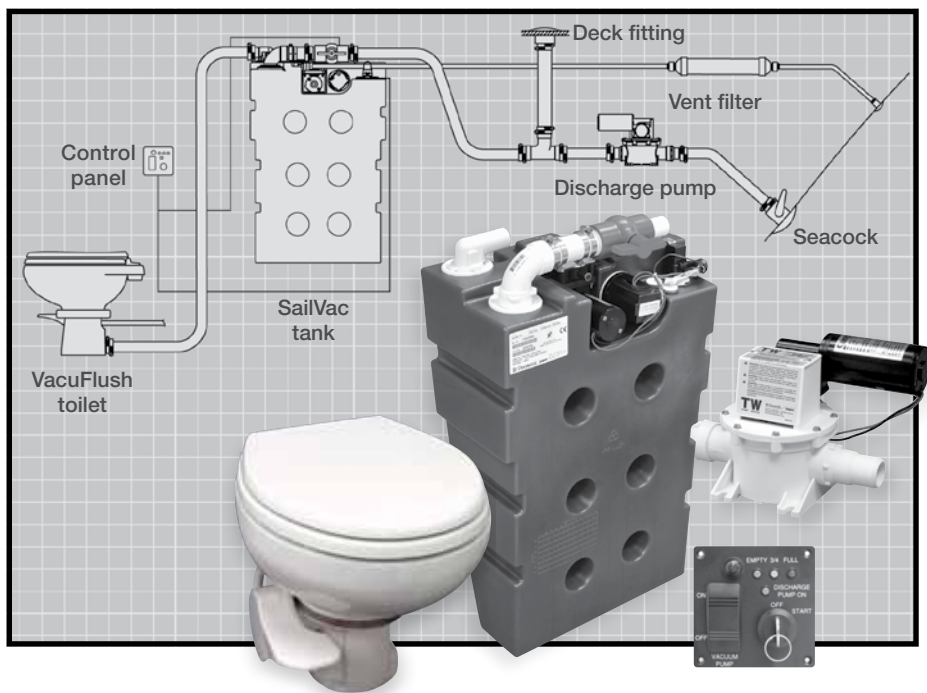

TOILET OPERATION • AVOIDING CLOGS
PUMP-OUT OPERATION • CLEANING

This guide applies only to VacuFlush toilet system that is custom-engineered for



VacuFlush® Toilet System

VacuFlush toilet – general use

Toilet system start-up

1. Fill freshwater tank.
2. Turn on electrical power and water supply to toilet system. When the system vacuum reaches operating level, the vacuum pump will shut off, and the toilet is ready for use.

Normal toilet operation

ADD WATER TO TOILET BOWL



Raise flush pedal until desired water level is reached. More water is usually added only when flushing solids. (If pedal is raised too long, water may overflow the toilet bowl.)

FLUSH TOILET



Press foot pedal sharply down until contents clear bowl. Hold foot pedal down for three seconds. After flush, let foot pedal snap back into position. If foot pedal is accidentally released before waste clears bowl, do not flush again until vacuum pump stops running. A small amount of water remains in bowl after flushing.

DO NOT FLUSH FOREIGN OBJECTS



CAUTION! Flush only water, bodily wastes and rapid-dissolving tissue paper. **Do not flush** wet wipes, sanitary napkins, condoms, diapers, razor blades, paper cups, cotton swabs, food, hair or liquids such as oils or solvents. Clogging or damage to the toilet system may occur.



Note

Make sure all guests understand toilet operation before use.

Use **RAPID-DISSOLVING** toilet tissue – avoid clogs



To avoid potential clogging problems with some household tissues, Dometic recommends the use of quick-dissolving tissue, such as SeaLand® Rapid-dissolving 1-ply or 2-ply Toilet Tissue.

IMPORTANT! NOT EVERY MARINE-GRADE TOILET PAPER DISSOLVES RAPIDLY

To determine any tissue's ability to dissolve, immerse one square of tissue in a jar of water and shake 5-10 times. The tissue sample should break up so that it is no longer in one piece.

Quick-Start Guide

Pumping out SailVac vacuum holding tank



Note

Operator must know local regulations for emptying a holding tank.



Caution!

Do not allow discharge pump to operate for an extended period of time when there is no discharge from holding tank. Damage to pump may result.



Caution!

Do not operate discharge pump if boat is equipped with a seacock and the seacock is CLOSED. Damage to pump may result.

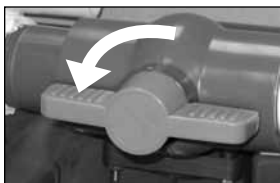

DURING DOCKSIDE DISCHARGE, MAKE SURE THE BALL VALVE IS OPEN AT TOP OF VHT. THE BALL VALVE IS LOCATED JUST INSIDE A WALL ACCESS PANEL IN THE HEAD COMPARTMENT.

DURING OVERBOARD DISCHARGE, MAKE SURE THE SEACOCK VALVE IS OPEN AND DECK FITTING IS TIGHTLY CLOSED.



VacuFlush® 5140 series vacuum toilets include a hold-open pedal lock. It holds the flush ball open to allow positive air pressure into the holding tank during pump-out. This helps assure thorough discharge of the tank.

1. Turn off water supply to toilet and electrical power to vacuum pump.
2. a. Press down fully on Pedal, then b. press Lock.
3. Slowly bring Pedal up while holding Lock down against Pedal until Pedal stops. Lock prevents flush ball inside the toilet bowl from closing.
4. Open ball valve on top of VHT or at seacock (if applicable). Start Discharge Pump at control panel and pump out holding tank. Let pump run for 4-5 minutes or until empty.
5. After pump-out is complete, press down on Pedal fully, then release to close flush ball.
6. Close ball valve at top of VHT and at seacock (if applicable).

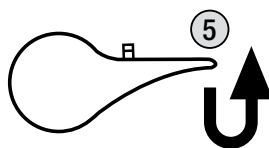
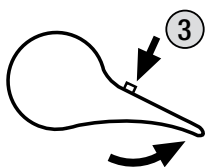
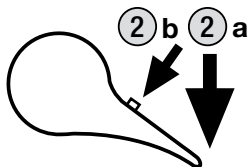
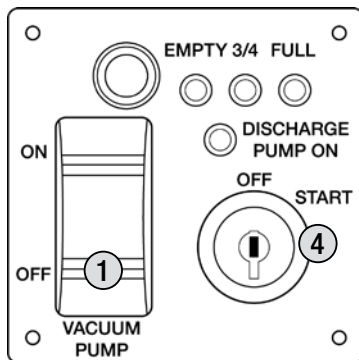

Cleaning the VacuFlush toilet system

For longest-lasting performance and maximum efficiency, the entire VacuFlush® toilet system should be cleaned according to the following conditions and procedure:

- constant, live-aboard style usage (every 2-3 months).
- if toilet will not be used for two weeks or longer.

ENTIRE VACUFLUSH SYSTEM:

1. Add water to toilet bowl until about half full.
2. Add 2 cups (0.47 l) of regular-strength liquid laundry detergent to water.
3. Press flush pedal down and hold for 3-5 seconds after bowl empties.
4. Completely pump out SailVac holding tank according to instructions in this guide.

Customer service

There is a strong, worldwide network to assist in servicing and maintaining your sanitation system. For the Authorized Service Center near you, please call from 8:00 a.m. to 5:00 p.m. (ET) Monday through Friday.

You may also contact or have your local dealer contact the Parts Distributor nearest you for quick response to your replacement parts needs. They carry a complete inventory for the SeaLand product line.

Telephone:	1 800-321-9886 330-496-3211	U.S.A. and Canada International
Fax:	330-496-3097 330-496-3220	U.S.A. and Canada International
Web sites:	http://www.Dometic.com http://www.SeaLand-Online.com	



For a complete operation and other information, refer your VacuFlush and SailVac owner's manuals, or call Dometic Corp., SeaLand Product Customer Service at 1-800-321-9886.