

30-900 Motor Home Door Hardware

FIELD CAMPAIGN



500 Bailey Avenue
New Hampton, Iowa 50659
Tel: 641-394-3188
Fax: 641-394-2392
1-800-447-0343
www.trimarkcorp.com



TriMark Europe
Magna Road, South Wigston
Leicester LE18 4ZH
United Kingdom
Tel: +44(0)116-278-7516
Fax: +44(0)116-277-6640



CONTENTS

1. BASIC COMPONENTS
2. TOOLS REQUIRED
3. DISASSEMBLY & ASSEMBLY
4. PARTS LIST
5. TROUBLESHOOTING
6. HOUSING ALIGNMENT

1. BASIC COMPONENTS

The 30-900 entrance hardware consists of five major components. (Fig. 1)

- Outside Housing Assembly
- Inside Plate Assembly
- Latch Assembly
- Latch Assembly Screws
- Inside Assembly Screws

2. TOOLS REQUIRED

Tools required for the disassembly and assembly of the 30-900 entrance hardware:

- Power screwdriver with T20 torx bit
- 5/32" allen wrench
- 7/16" thin-walled nut driver

3. DISASSEMBLY & ASSEMBLY

DISASSEMBLY (Fig. 1)

1. Remove sticker covering the nut adjusting hole on door edge.
2. Remove locknut from rod through hole on door edge.
3. Loosen and remove 3 inside plate assembly mounting screws. Remove red vinyl cap from silver lock pin.
4. Pull inside plate assembly away from the door. Remove outside housing assembly from the door.
5. Remove latch assembly from door as follows:
 - Remove latch assembly mounting screws.
 - Pull latch assembly away from door edge. (Fig. 2)
 - Rotate latch assembly to remove the latch from the door. (Fig. 3) Actuation of the trip lever may be necessary to remove the latch from the door frame.
6. Disable and discard entire assembly.

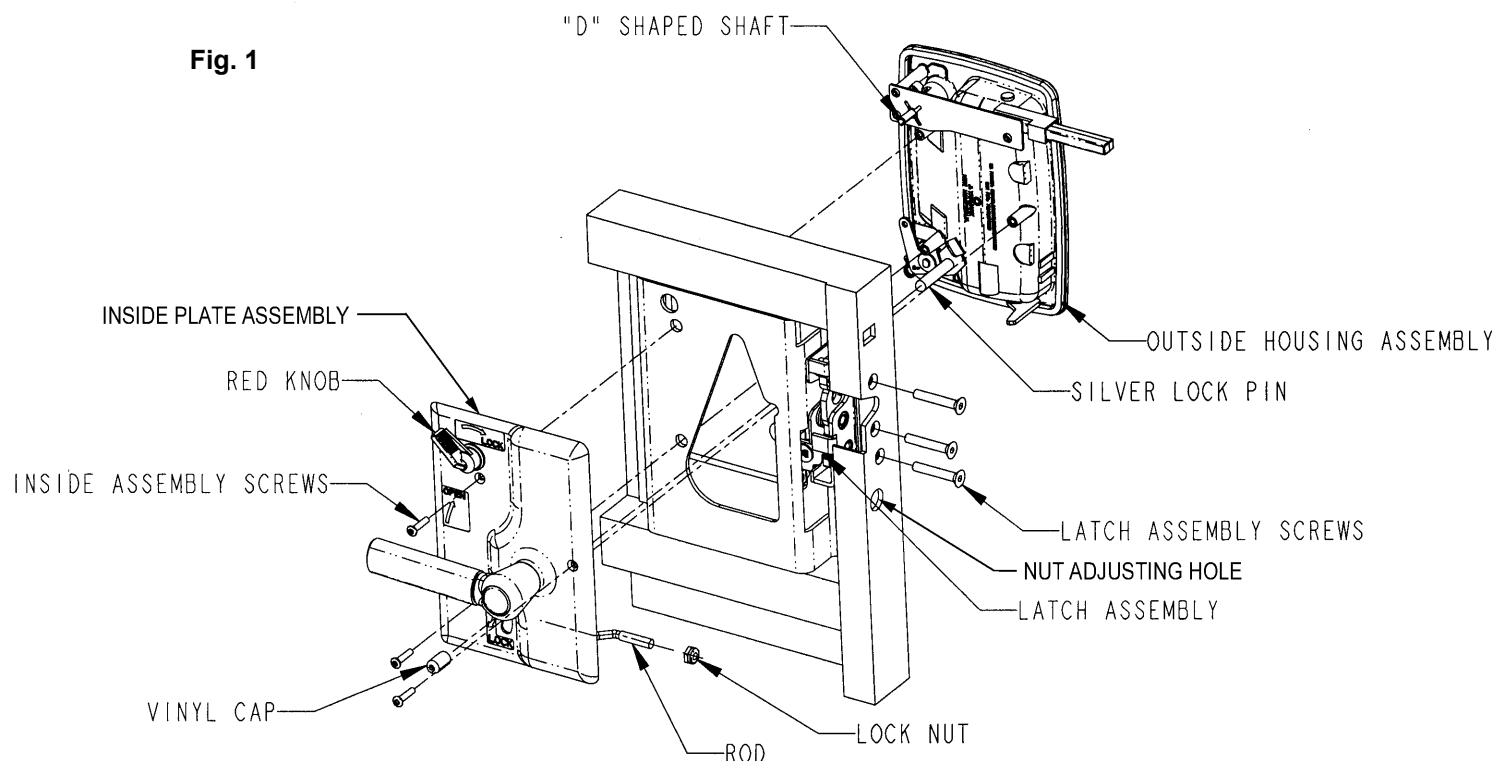

ASSEMBLY

1. Install latch assembly into door frame.
Tighten three latch mounting screws and torque to 10 ft-lbs.
2. Place outside housing assembly into door cutout. Hold this position. Attach inside plate assembly. (Remove lock nut and insert rod through trip lever hole.) Align "D" shaped shaft with red knob. Insert silver lock pin into slot of inside plate assembly. Slightly turn the inside handle into the open position and press the inside plate assembly onto outside housing. (Fig. 5)
3. Install the 3 inside plate mounting assembly screws on inside plate assembly and torque to 13 in-lbs. Make sure outside housing assembly is in straight before tightening.

Fig. 2

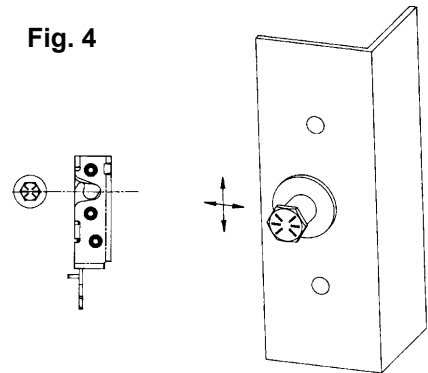

Fig. 3



4. Install lock nut to rod through nut adjusting hole. (Fig. 5)
5. Adjust nut.
 - Close the latch
 - Lock the handle from the inside
 - While pulling up on the inside handle, manually (no power) turn the nut clockwise until the latch releases
 - Manually turn the nut counterclockwise 1-1/4 to 1-1/2 turns
 - Unlock the door and open the door from the inside handle. The latch should release before the inside handle reaches maximum travel
 - CHECK TO MAKE SURE THE INSIDE HANDLE DOES NOT OPEN THE DOOR WHEN IT IS LOCKED.
6. Install red vinyl cap.
7. Operate to make sure the inside and outside handles operate smoothly. Place lock pin in locked position. Attempt to operate handles. Latch should not open.
8. Operate the deadbolt to make sure that it extends and retracts smoothly.

Fig. 4



9. Check the alignment of the striker bolt and the rotary latch. Adjust the striker bolt up and down as needed. Mark the frame around the top and bottom of the washer on the striker bolt. (Fig. 4)
10. Close the door and check that the latch engages into the fully latched position. On this latch there are 2 closed positions, fully latched and a secondary safety catch. Adjust the striker bolt in and out as necessary.
11. After adjusting the striker bolt for smooth operation and full latching, torque the striker bolt to 35 in-lbs.
12. Install sticker to cover nut adjusting hole on door edge.

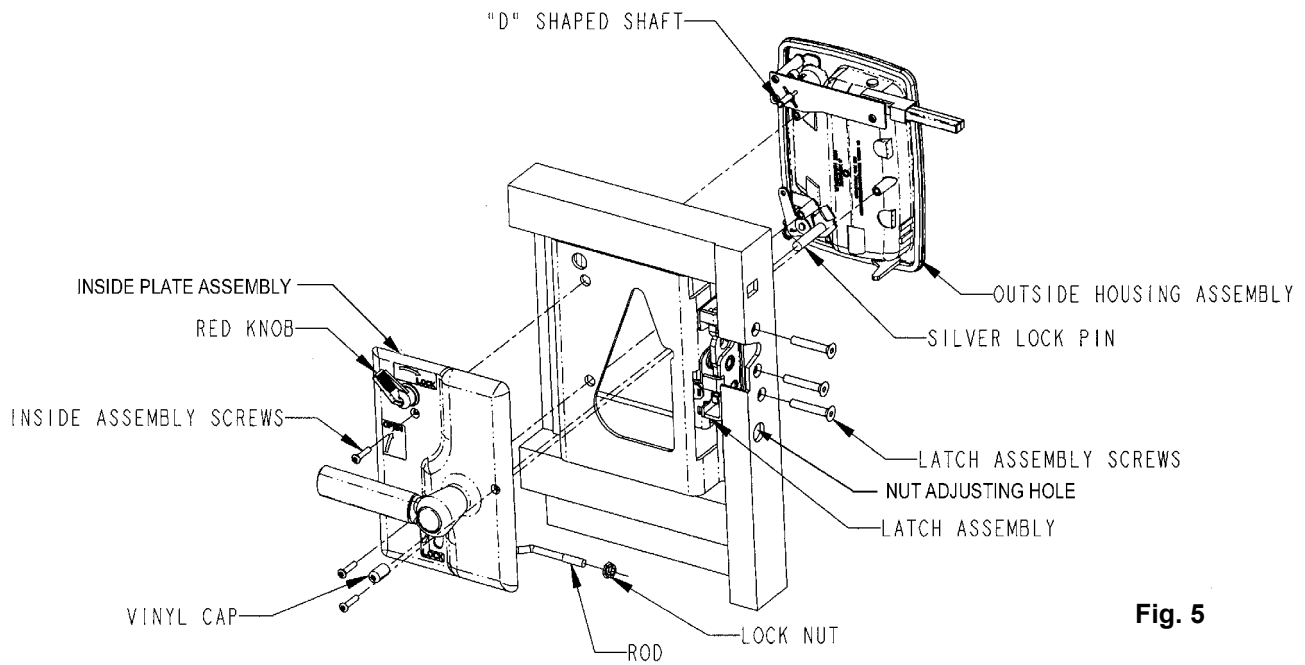

Fig. 5

4. PARTS LIST

TRIMARK PART	QTY	DESCRIPTION
13748-02	1	Inside Plate Assembly
15555-01	3	#8-32 UNC X 5/8 Screw
17999-01	1	Latch Assembly
81066-39	3	1/4-20 UNC X 3/4 Screw, Grade 5 or better
16004-01	1	Outside Housing Assembly

5. TROUBLESHOOTING

SYMPTOM	PROBLEM	POSSIBLE REMEDY
Housing moves when opening & closing	Housing loose	Check housing alignment - Sec. 6 Retighten screws.
Handles operate roughly	Housing-Latch alignment Striker Bolt- Latch alignment	Check housing alignment - Sec. 6 Lubricate contact points of levers Adjust striker bolt - steps 9, 10, 11
Handles difficult to operate at all times	Housing-Latch alignment Striker Bolt- Latch alignment	Check housing alignment - Sec. 6 Lubricate contact points of levers Adjust striker bolt - steps 9, 10, 11
Handles difficult to operate when closed but easy when open	Striker Bolt-Latch alignment	Adjust striker bolt - steps 9, 10, 11
Unit will not lock	Housing-Latch alignment	Check housing alignment - Sec. 6
Unit will not open	Housing-Latch alignment Striker Bolt-Latch alignment Latch Binding	Check housing alignment - Sec. 6 Adjust striker bolt - steps 9, 10, 11 Inspect latch

6. HOUSING ALIGNMENT

Remove inside plate assembly. Push outside housing and assembly as far towards the frame as possible. Hold in this position. Align "D" shaped shaft with red knob. Insert silver shaft into slot in inside plate assembly. Slightly turn the inside handle into the open position and press plate assembly onto housing assembly. Recheck to make sure housing is positioned correctly. Install inside plate assembly with 3 mounting screws, tighten and torque to 13 in-lbs.