



SLIDE TOPPERS



What is it and what does it do?

- Slide out room cover
 - *Protect from debris*
 - *Prevent weather damage*



OEM vs. Aftermarket

OEM SLIDE TOPPERS

Style Number	Weathersheild
86099**	Vinyl
86100*	Metal
86101*	Vinyl
86102^	Metal
86103^	Vinyl
86200*/86202	Full Cover

AFTERMARKET SLIDE TOPPERS

Style Number	Weathersheild
85097	Vinyl
85096	Metal
86097	Vinyl
86096	Metal
86302	Metal
86196	Full Cover



Application Selection

- What size?
 - Room size (Flange to Flange)
 - Note fabric will not be the size the slide topper is ordered at.
 - All room measurements in the guide are based off a 3 inch flange size
- Which Brackets?
 - What style bracket?

Measuring

- Flange to Flange

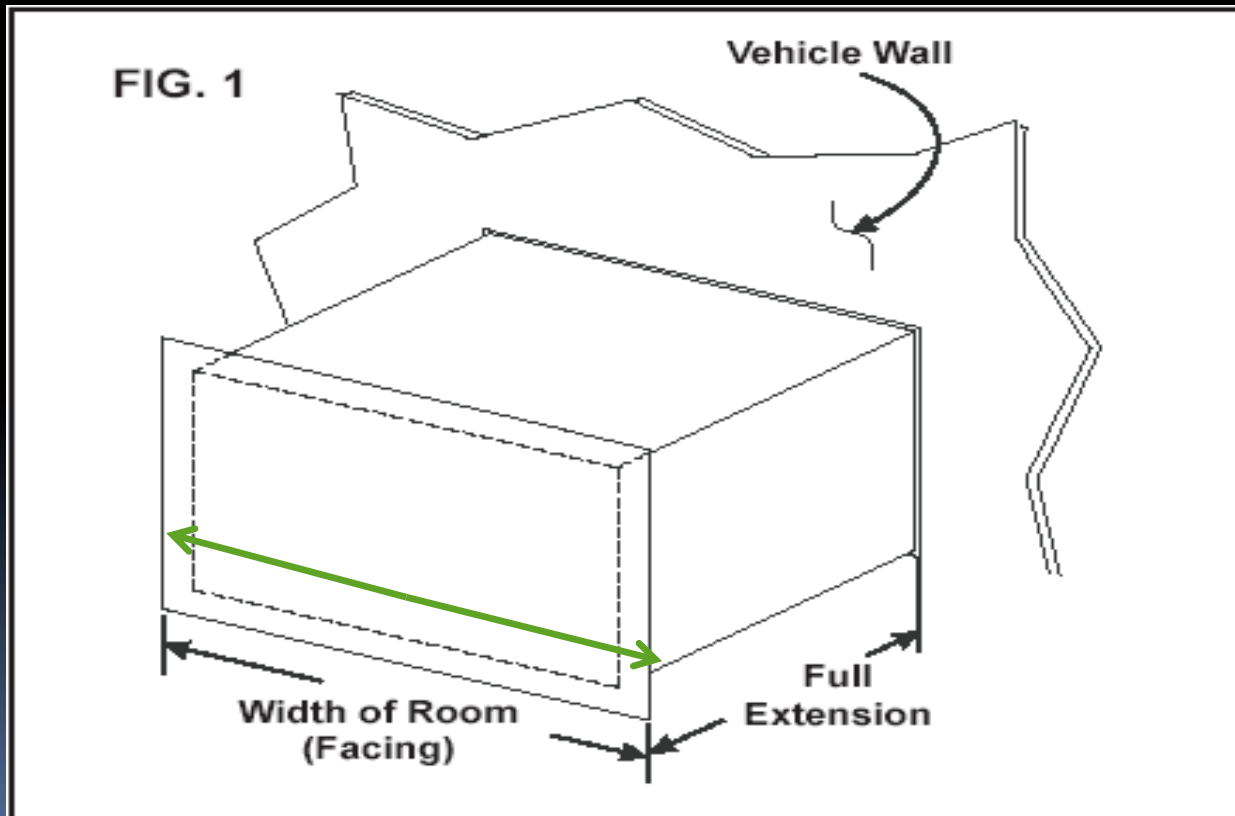

Deciding Fabric Size

- Take the length described in the part number (i.e. 86097CQ.168-B) and deduct 5 inches off.
 - $168 - 5 = 163$ inches of fabric
- The fabric will have a +/- .5 inch variation from time to time.
 - This is why we “over compensate” the sizes ever so slightly



Brackets

- Attachment hardware Styles
 - 45 Degree
 - 90 Degree
 - Specialty Bracket
 - 3106992.xyyz
 - X: Hex Bar Extension
 - Y: Style
 - Z: Hardware Color
- 

45 Degree

FIG. 3

Mounting Bracket
(Kit # 3106992.X39X, .X54X, & .096X)

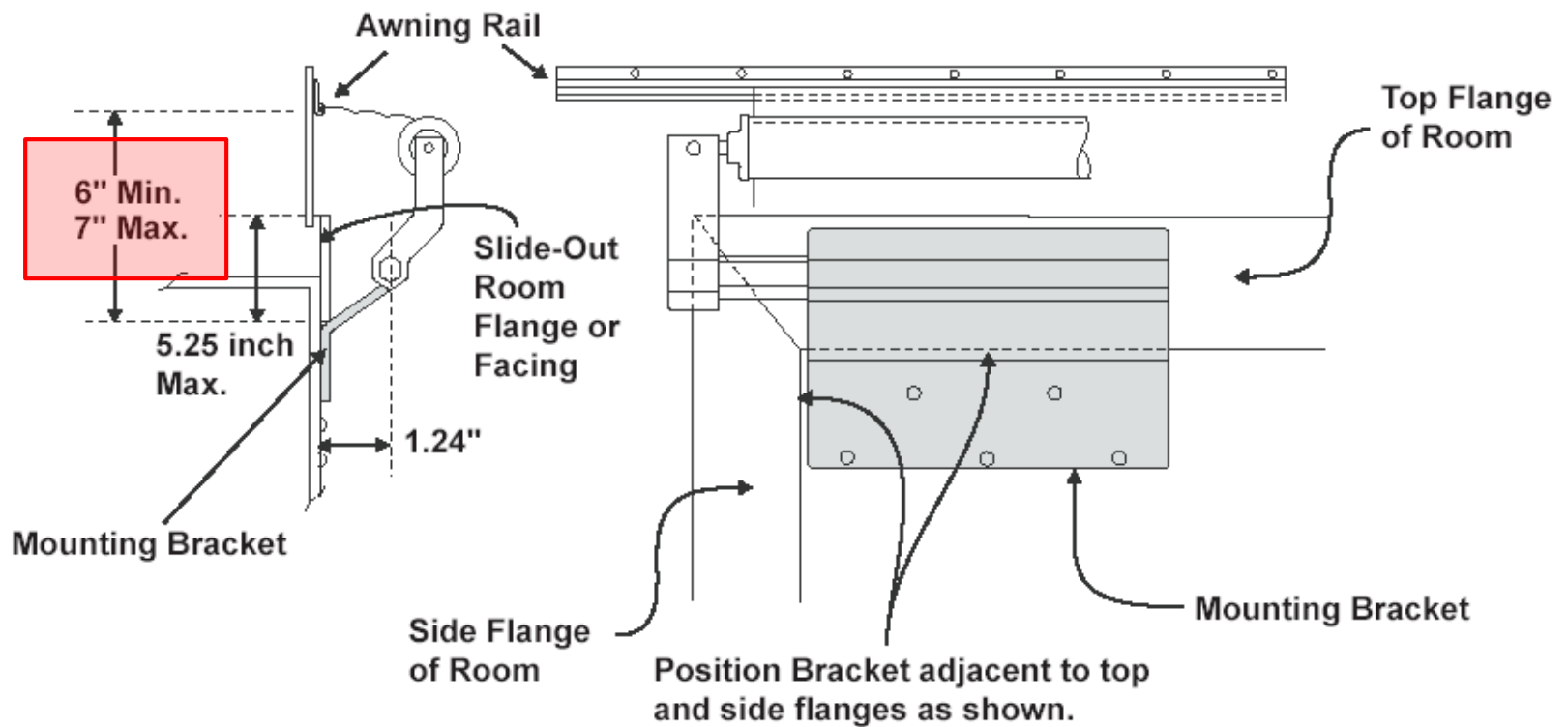

90 Degree

FIG. 4

Mounting Bracket
(Kit # 3106992.X47X, & .088X)

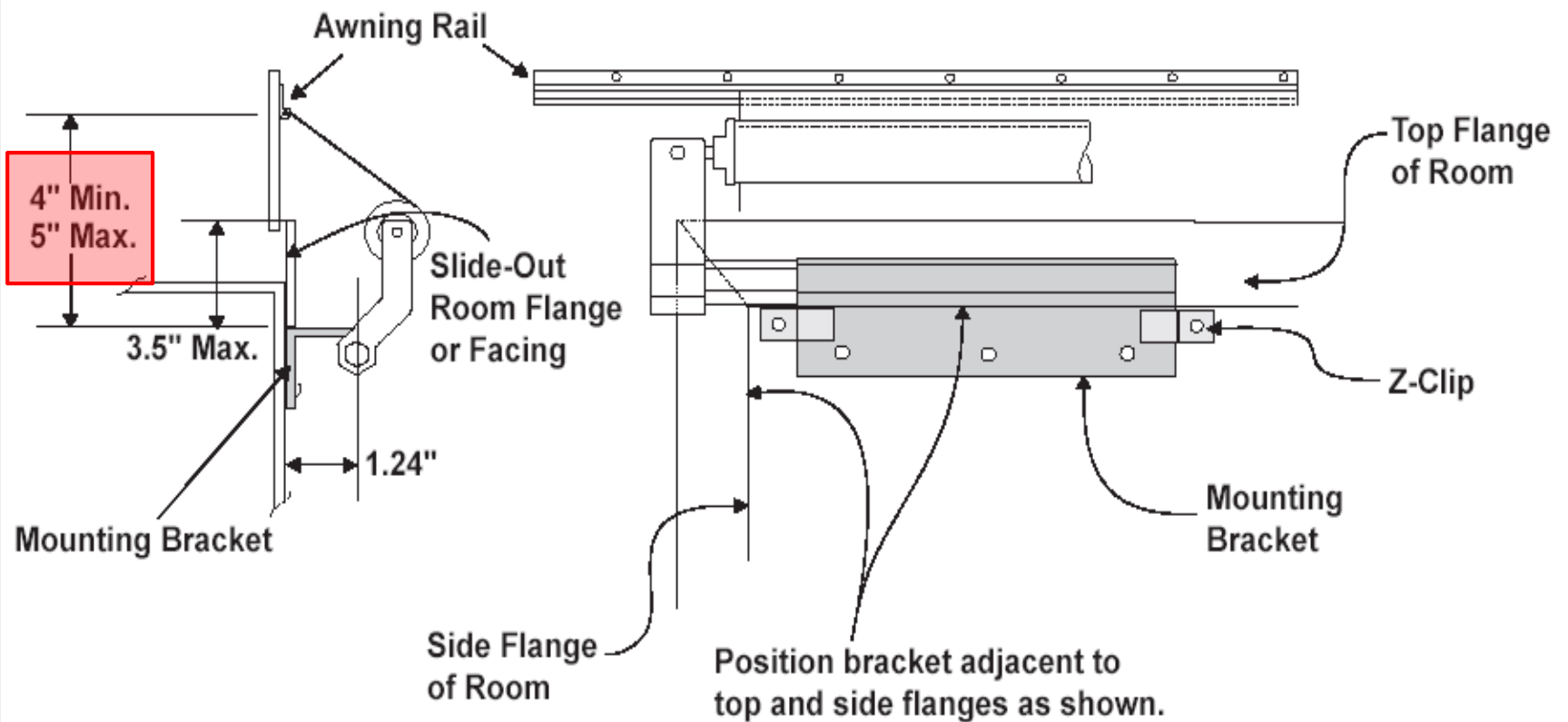

Specialty Bracket

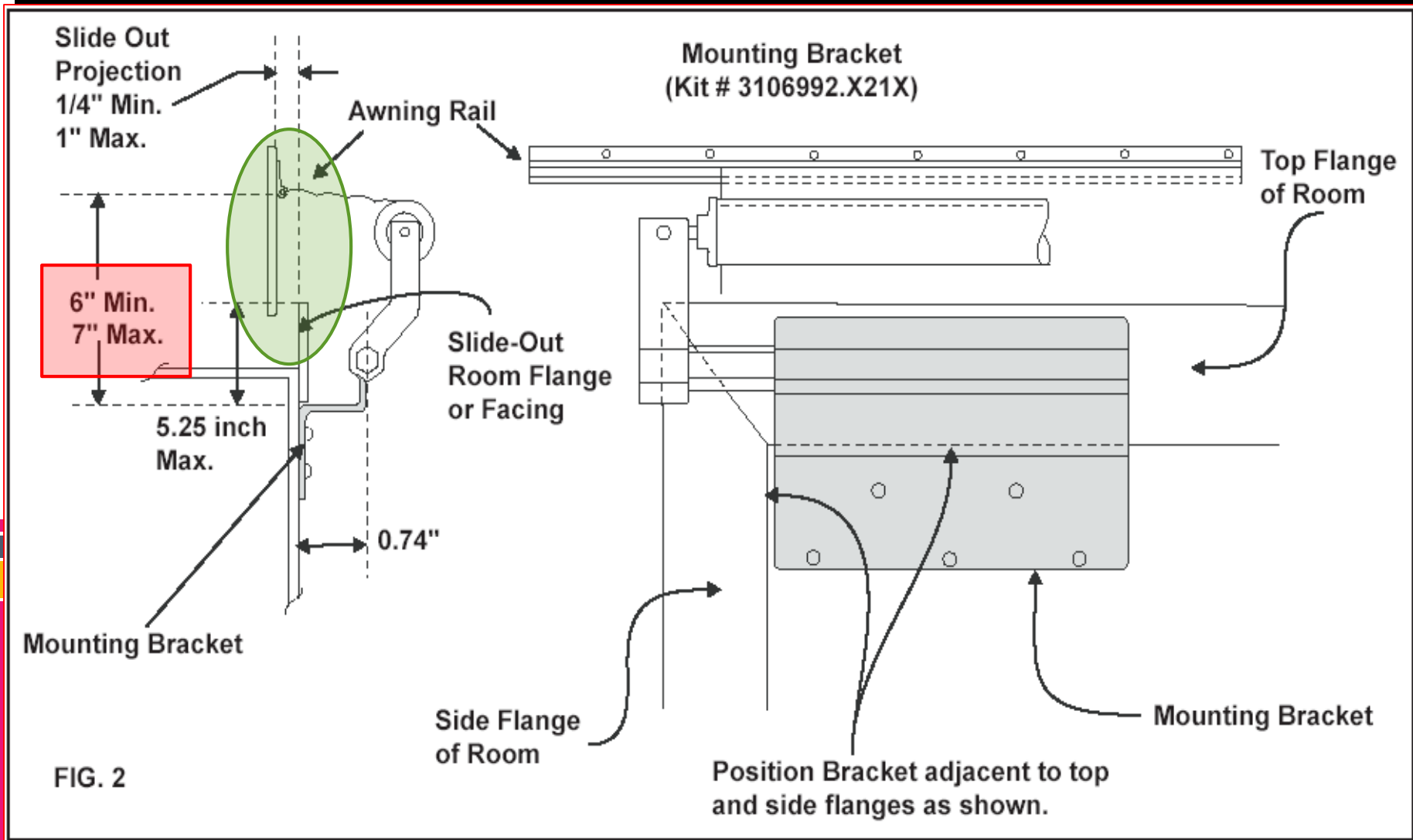

Spacer Kit

- Used for Large / Bowed Flanges

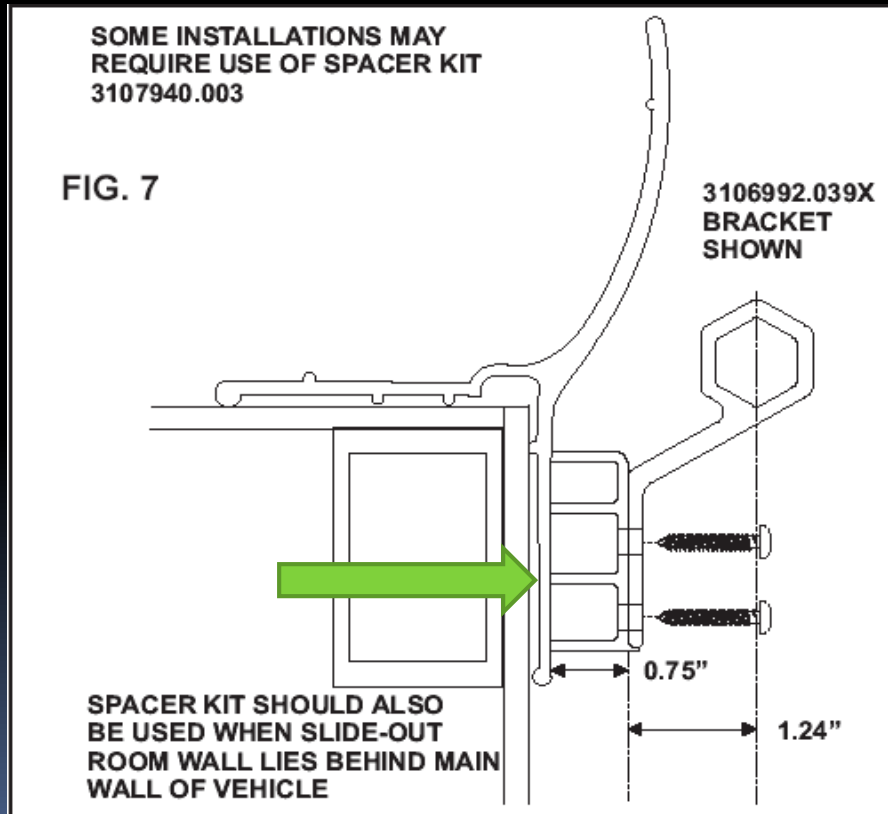

Spacer Kit

- Used when Slide out room is in Recessed Wall

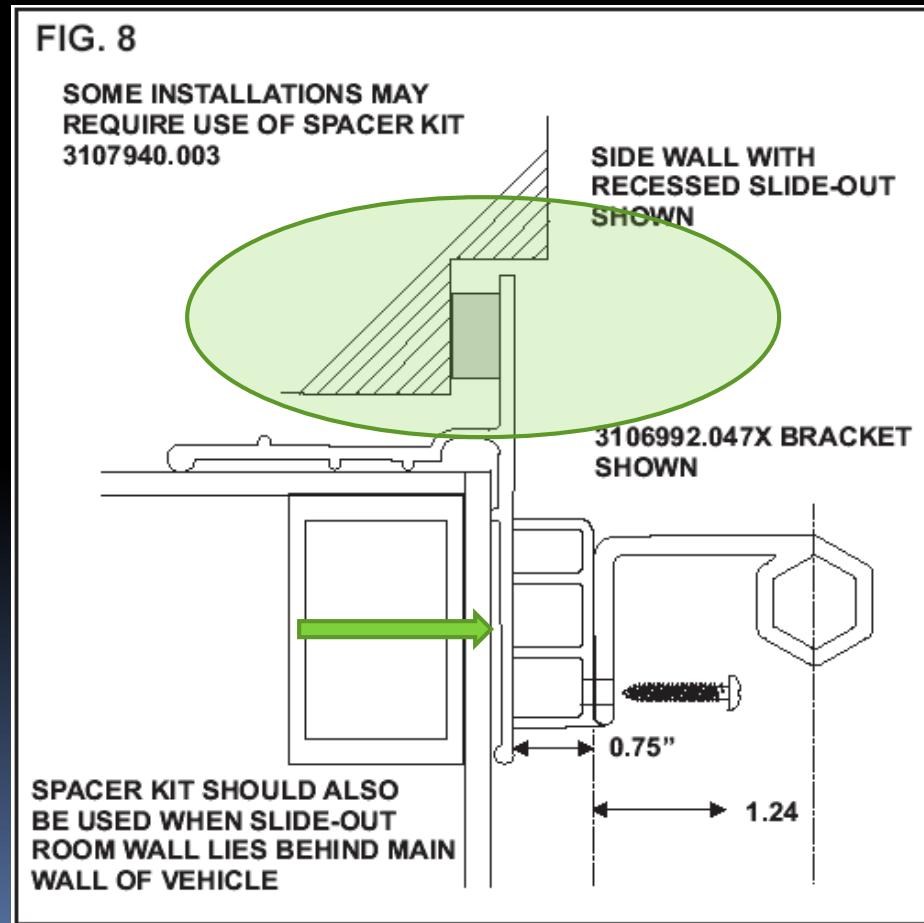

Oversized Slide Toppers

- Any size 198" and over
 - 86102 & 86103 models
- Requires the "Heavy Duty" Brackets
 - Includes an Anti-billow Kit
- Also needs a Cradle, Awning Rail, & 2nd Anti-billow Kit



Installation

- Awning Rail
 - Assemble Extension
 - Mount Brackets
 - Align Fabric
 - Remove Cotter Pins
 - Install Lock Mechanism
- 

Awning Rail

FIG. 9

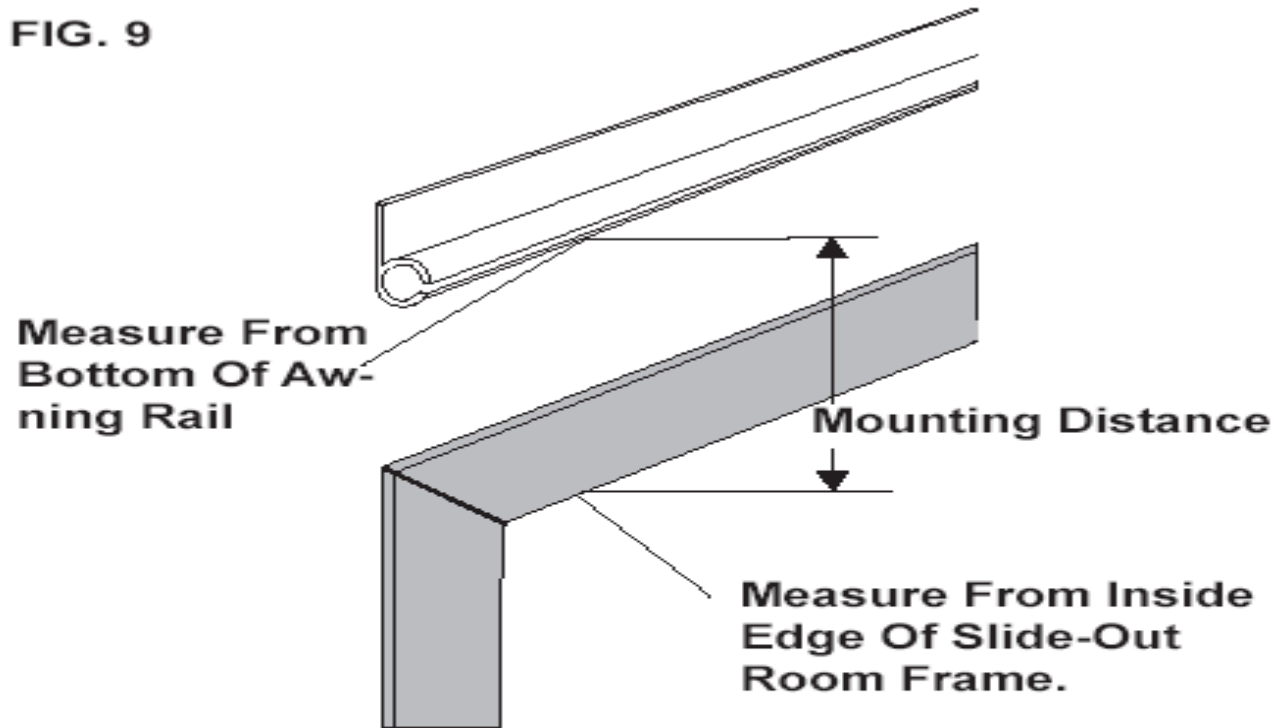

Mounting Distance	
MNTG BRKT 3106992.X21X	6" - 7"
MNTG BRKT 3106992.X39X	6" - 7"
MNTG BRKT 3106992.X47X	4" - 5"
MNTG BRKT 3106992.X88X	4" - 5"
MNTG BRKT 3106992.X96X	6" - 7"

Assemble Extension

- Rivet both Extensions
- Unwind ONE Wrap of Fabric
- Attach Wall Brackets

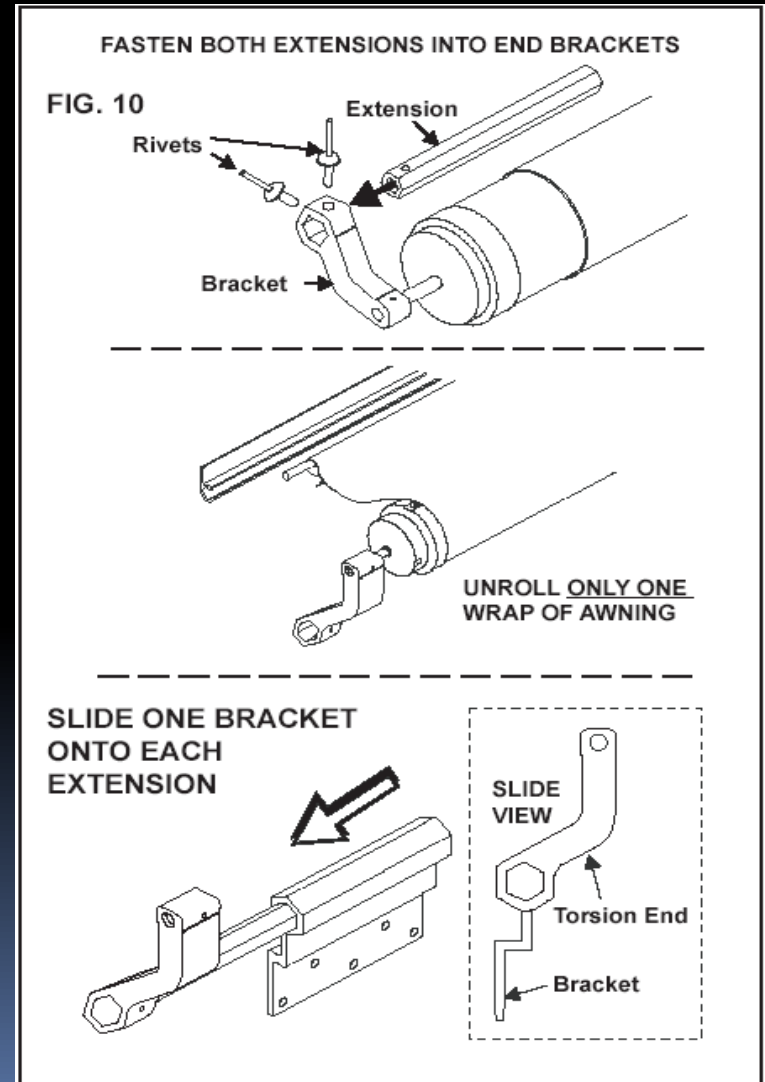

Mount Brackets

- Fasten bracket to wall at inside corners
 - Room must be completely closed
- Use Z-clip Brackets and Oscar Rivets
 - Required for 90 Degree brackets and laminated surfaces

FIG. 11

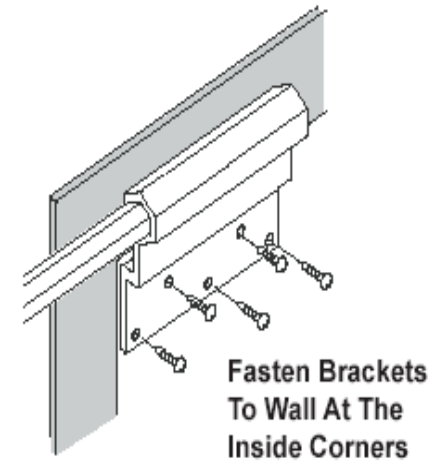
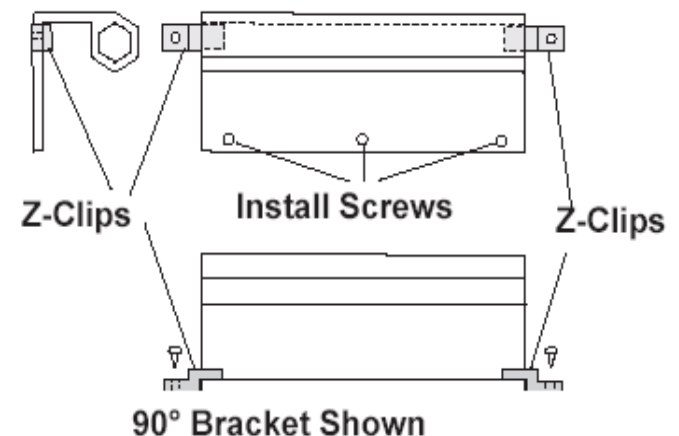
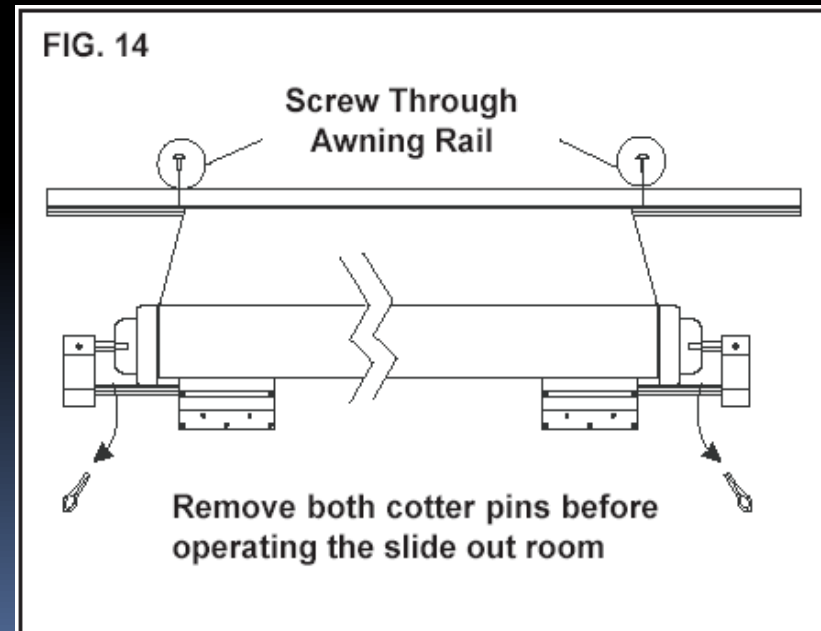

FIG. 12



Fabric and Cotter Pins

- Center awning tube and lock into position with supplied self drilling screws
- Straighten and remove cotter pins from both sides of Slide topper
 - Check to see if tube is free to rotate
- Open and close several times to center the fabric
 - Once Centered, install screw through Awning rail and fabric on both ends



Lock Mechanism and Stopper

- Position Lock on end cap at either end
 - XL Slide Toppers will require one at both ends
- Position bumper straight up, if possible.
 - Going as far as a 2 o'clock position is acceptable
- Attach using supplied screws
- Set up stopper to keep lock from going past a 45 Degree angle when tube is rotated by hand toward the wall

Lock Mechanism and Stopper

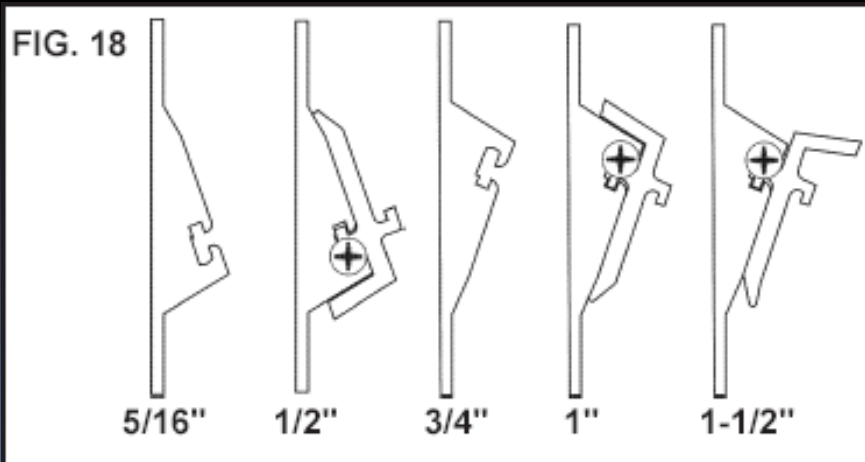
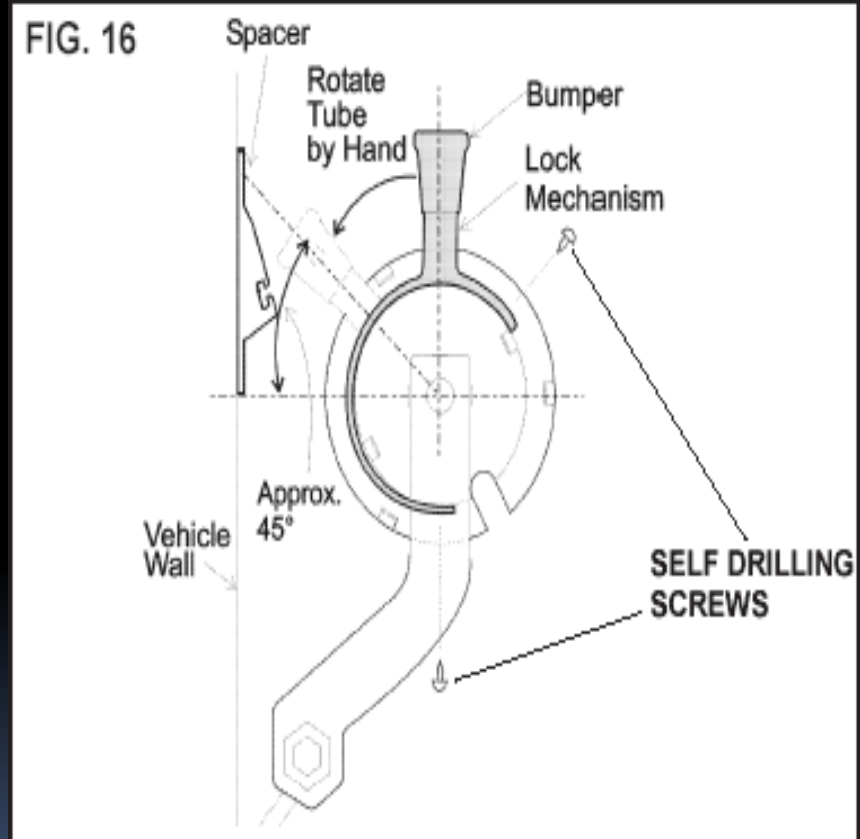
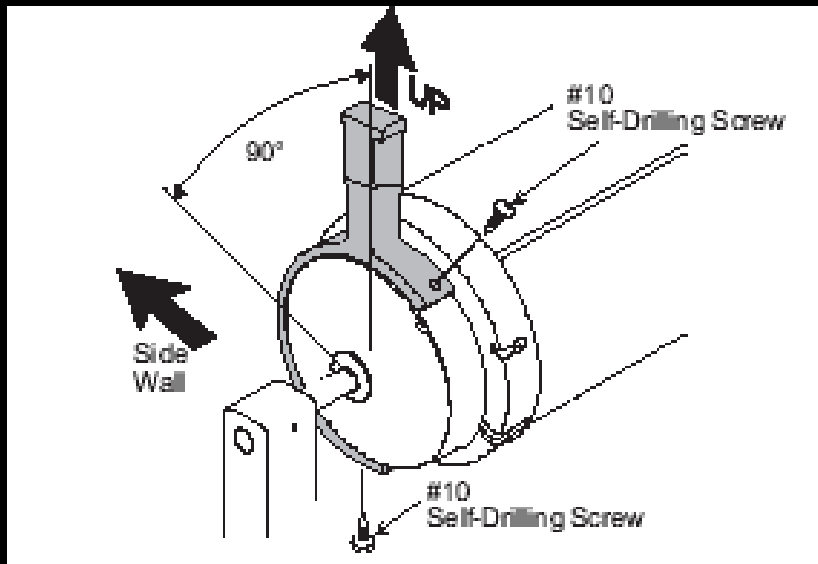



Operation

- Slide topper auto opens and closes as room is slid in and out.
 - Since awning is level, water may puddle on top of the canopy.
 - As the room is closed, the puddles will spill over the sides of the awning.
- 



Last Minute Advice

- We recommend not using slide toppers in snowing or freezing-rain conditions.
 - This could prevent the awning from closing and possibly do damage to the awning AND the room.



Thank you!

**~Smile, you were
designed that way~**