

## Mini-Heki plus



Outside view



Inside view

## Inside frame, outside frame, and dome

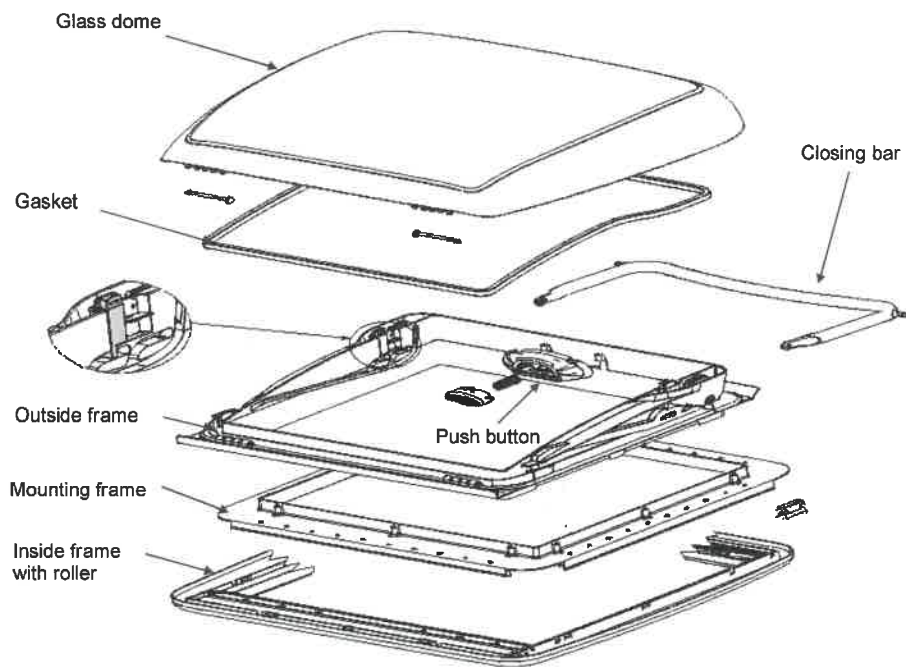

### **PROBLEM:**

- Replacing the glazing dome**
- Replacing the gasket ring**
- Replacing the closing bar**
- Replacing the pushbutton**
- Replacing the installation frame**
- Replacing the inside frame with roller blinds**

### Replacing the glazing dome

Refer to the replacement instructions for the glazing dome.

### Replacing the gasket ring



Remove the rubber gasket from the groove of the glass dome with a blunt scraper or a screw driver. Secure the new rubber gasket in the groove and the butt ends together with super glue.

**Attention:** If the rubber gasket cannot be replaced while the glass dome is installed then remove the glass dome as described under **Replacing the glazing dome**.

### Replacing the closing bar



Open the skylight all the way. Now press together the hinge bolts on the closing bar mounting of the glass dome and pull them out from the side. Remove the closing bar via the side guide channel and install the new bar in the reverse order of sequence.



**Attention:** The guide pegs on the side of the closing bar are not located on center (eccentric) therefore the guide pegs must be in the exact same position during installation as when the bar is removed. This will ensure proper function.

### Replacing the pushbutton



Open the skylight all the way. Loosen both of the screws that are located above the pushbutton and then push the pushbutton out through the top. Insert the new pushbutton from the top and tighten the screws.

### Replacing the installation frame



Remove the inside frame as described under **Replacing the inside frame with roller blinds**. Loosen the screws on the installation frame (12 screws) and pull out from the bottom. Insert the new installation frame into the cutout and screw in place.

**Attention:** Make sure that the wall has the correct thickness when replacing the installation frame otherwise the construction may leak. The screw dome must be cut according to the thickness of the wall (see the installation manual).

Make sure the notches are in the correct position before clipping the inside frame in place.

### Replacing the inside frame with roller blinds



Loosen one of the inside frame corners carefully by hand and remove it by pulling it lightly downward.

Make sure the notches are in the correct position before clipping the inside frame in place.