



STEERING SYSTEMS

STEERING ACCESSORIES

INSTALLER: THESE INSTRUCTIONS CONTAIN IMPORTANT SAFETY INFORMATION AND MUST BE FORWARDED TO MARINE CRAFT OWNER.

EN Steering Connection - Splashwell Mount

Service Kit Instructions

USA & CANADA

Service Office
Dometic Corporation
640 N. Lewis Road
Limerick, PA 19468
610-495-7011 ext. 2
ts.mechanical@dometic.com

Service Center & Dealer Locations

Visit: dometic.com

This SKI contains important supplementary information or notifications for the Steering Connection - Splashwell Mount (hereinafter referred to as "product"). It is not intended to provide all information, instruction, and/or safety messaging related to the product. For complete information, refer to the product manuals.

The product provides a thru-wall mounting for steering cables manufactured by Dometic and is designed for use with splashwells up to 30 in. (760 mm) wide. The product is not designed to go through the transom of the boat. It is for use in the splashwell area only.

| SA27253P Kit Contents | Qty. |
|-------------------------|------|
| Boot and Wiper Assembly | 1 |
| Support Tube | 1 |
| Ball, Gimbale | 1 |
| Ball, Retainer | 1 |
| Bolt, Carriage 1/4 -20 | 6 |
| Washer, Flat 1/4 ID | 6 |
| Lock Nut, 1/4-20 | 6 |
| Clevis Kit | 1 |
| Spanner Wrench | 1 |

 The images used in this document are for reference purposes only.

Before beginning with installation, confirm the contents of the service kit are present.

1 Explanation of Symbols and Safety Instructions

This manual has safety information and instructions to help you eliminate or reduce the risk of accidents and injuries.

1.1 Recognize Safety Information

 **This is the safety alert symbol.** It is used to alert you to potential physical injury hazards. Obey all safety messages that follow this symbol to avoid possible injury or death.

1.2 Understand Signal Words

A signal word will identify safety messages and property damage messages, and it will indicate the degree or level of hazard seriousness.

 **WARNING**
Indicates a hazardous situation that, if **not** avoided, could result in death or serious injury.

NOTICE: Used to address practices **not** related to physical injury.

 Indicates additional information that is not related to physical injury.

1.3 General Safety Messages

⚠ WARNING: STEERING CONTROL HAZARD.
Failure to obey the following warnings could result in death or serious injury:

- The boat should be operated with caution until the steering system has been thoroughly checked out under normal operating conditions to ensure that the installation is correct and complete.
- Read these instructions thoroughly before beginning installation.
- Use the parts provided only as instructed and only use the parts provided. Do **not** substitute parts.

NOTICE: In order to obtain the best steering performance, the outboard motor must be installed and lubricated and the trim tab adjusted in accordance with the motor and boat manufacturer's specifications.

2 Preparation

NOTICE: A minimum splashwell wall thickness of 0.5 in. (13 mm) is required for installation of this kit.

- This minimum dimension may be met by reinforcing the mounting area with marine plywood of the appropriate thickness.
- It is essential that the structural integrity of the splashwell wall be sufficient to withstand all steering loads which may be imposed on it.

This section describes the procedure for preparing the splashwell for mounting the steering cables.

2.1 Preparing the Splashwell Mount

NOTICE: The mounting location **must** be on the same side of the boat as the steering cable routing.

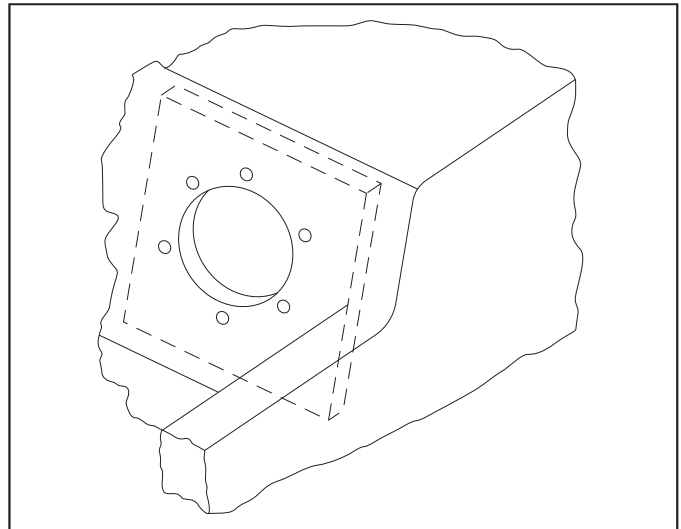

1 Reinforcing Block Position

1. Use the template to mark the mounting and clearance holes. See "Splashwell Template" on page 5.
2. Drill the mounting and clearance holes.
3. If a reinforcing block is necessary, fabricate it using the same hole sizes and configurations as the template.
4. Install the reinforcing block behind the splashwell wall.

3 Installation

This section describes the proper technique to install the splashwell mount and motor connection.

3.1 Installing the Splashwell Mount

⚠ WARNING: STEERING CONTROL HAZARD.

The coupler nut **must** be tightened securely to provide integrity of connection. Separation of the coupler nut from the support tube will result in loss of steering control. Failure to obey this warning could result in death or serious injury.

NOTICE: The gimbal assembly (gimbal ball retainer, gimbal ball, and support tube) have been pre-assembled. Do **not** separate these parts.

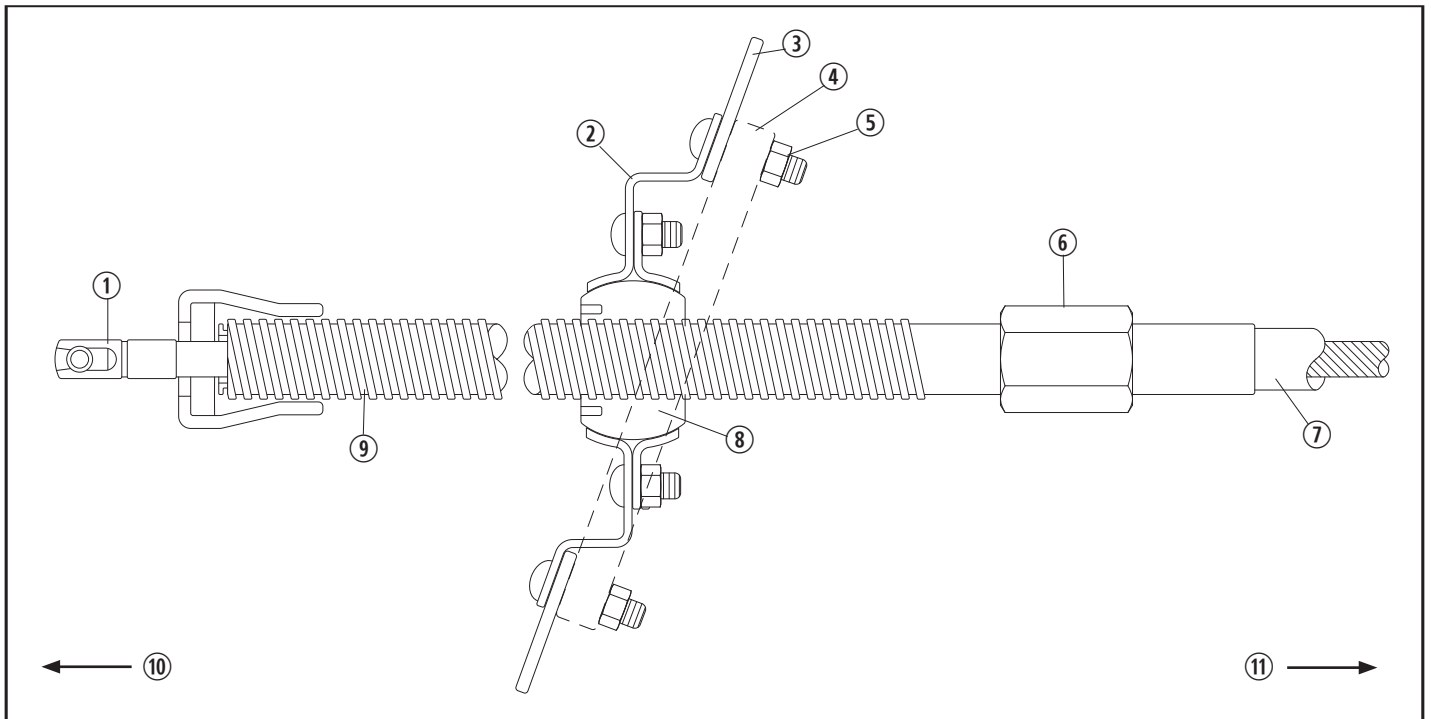

2 Splashwell Mount Components

- | | |
|------------------------------|-------------------|
| ① Telescopic End of Cable | ⑦ Steering Cable |
| ② Gimbal Ball Retainer | ⑧ Gimbal Ball |
| ③ Splashwell Wall | ⑨ Support Tube |
| ④ Reinforcing Block* | ⑩ Boat Centerline |
| ⑤ Bolt, Washer, and Lock Nut | ⑪ Outboard |
| ⑥ Coupler Nut | |

* If used

- Position the gimbal assembly to the splashwell, using a reinforcing block if necessary. [What is the gimbal assembly?

i The “boot” end of the support tube must point towards the centerline of the boat.

- Secure the assembly to the splashwell wall using carriage bolts, washers, and lock nuts, torquing the nuts to **75 lb in. (8.5 Nm)**.

i Do **not** exceed **100 lb in. (11.3 Nm)**.

- Install the boot and wiper assembly to the support tube, seating firmly.
- Lubricate the support tube and the telescopic end of cable with a waterproof, marine grade grease.
- Insert the telescopic end of cable through the support tube.

- Thread the coupler nut to the support tube and tighten securely [approximately **15 lb ft (20.3 Nm)**].

i Grip the support tube with a strap wrench or an equivalent tool which will not cause surface damage or collapse to the tube. A 1-1/4 in. open-end wrench may be used to turn the coupler nut.

3.2 Installing the Motor Connection

⚠ WARNING: STEERING CONTROL HAZARD.

Do **not** rotate the support tube during adjustments. This may loosen the coupler nut and cause loss of steering control during operation. Failure to obey this warning could result in death or serious injury.

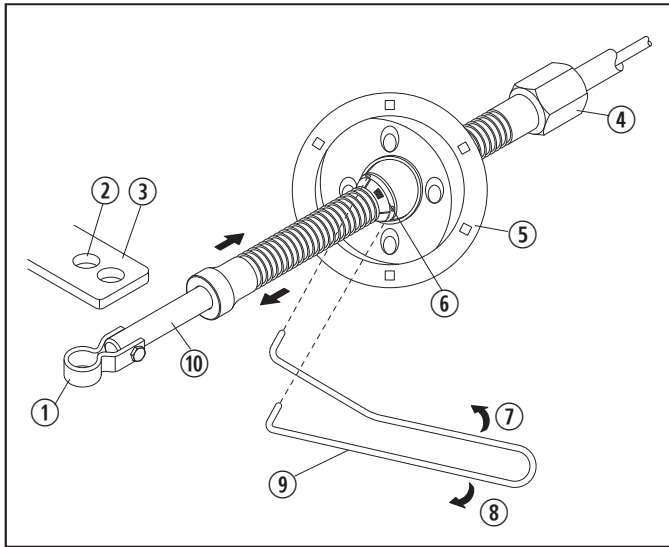

3 Motor Connection Components

- | | |
|---------------------|-------------------------|
| ① Clevis* | ⑥ Gimbal Ball |
| ② Mounting Hole | ⑦ Retracts Tube |
| ③ Engine Tiller Arm | ⑧ Extends Tube |
| ④ Coupler Nut | ⑨ Spanner Wrench |
| ⑤ Gimbal Assembly | ⑩ Telescopic Output Ram |

* See the clevis kit instructions.

- Follow the instructions in the clevis kit to install the clevis on the telescopic ram.
- Place the telescopic output ram in mid-travel position by rotating the steering wheel until the telescopic output ram is fully retracted, then rotate the steering wheel in the opposite direction approximately one and one-half turns.
- Center the engine tiller arm in a straight-ahead position.
- Insert the tips of the spanner wrench into the holes in the gimbal ball.
- Rotate the gimbal ball with the spanner wrench. Adjust until the hole in the clevis pin (with the telescopic in mid-position) aligns with the tiller arm hole. The motor should be straight-ahead.
 - i** Hold the support tube securely during adjustment. Rotation of the support tube can cause loosening of the coupler nut.
- Follow the instructions in the clevis kit to attach the clevis to the tiller arm.

- Move the motor through the normal operating positions (side-to-side and tilting up and down) to be certain no interference or restriction of movement exists.

4 Maintenance

⚠ WARNING: STEERING CONTROL HAZARD .

Loosening or separation of one or more fasteners may cause failure in the steering system. Failure to obey this warning could result in death or serious injury.

This section describes maintenance practices to follow once the product installation is complete.

- After a few hours of operation following the installation and periodically thereafter, re-torque all the fasteners and check the steering for security and integrity.
- Flush the telescopic area (cable output end) with fresh water after operation in salt water.
- Periodically remove the telescopic ram from the support tube, clean the ram and the tube, then lubricate with a waterproof marine grease.
- When storing the boat for an extended period, lubricate the output ram when fully extended, then retract completely for storage.
- Inspect periodically for corrosion. All metal parts meet or exceed the applicable specifications for corrosion resistance; however, with extended operation under extreme conditions, corrosion may occur and affected parts should be replaced.

5 Disposal



Place the packaging material in the appropriate recycling waste bins, whenever possible. Consult a local recycling center or specialist dealer for details about how to dispose of the product in accordance with all applicable national and local regulations.

6 Warranty Information

LIMITED TWO-YEAR WARRANTY AVAILABLE AT
WWW.SEASTARSOLUTIONS.COM/SUPPORT-2/WARRANTY-2/SEASTAR-SOLUTIONS-WARRANTY.

IF YOU HAVE QUESTIONS, OR TO OBTAIN A COPY OF THE LIMITED WARRANTY FREE OF CHARGE, CONTACT:

DOMETIC CORPORATION : SEASTAR SOLUTIONS
640 NORTH LEWIS ROAD
LIMERICK, PENNSYLVANIA 19468
1-610-495-7011

TS.MECHANICAL@DOMETIC.COM

7 Splashwell Template

If this template has been downloaded electronically or copied from another document, please check all dimensions on the template before cutting anything. Different printers or copiers may scale differently.

**INSTALLER: THESE INSTRUCTIONS CONTAIN IMPORTANT SAFETY INFORMATION
AND MUST BE FORWARDED TO MARINE CRAFT OWNER.**

