

**USA**

SERVICE OFFICE  
Dometic Corporation  
1120 North Main Street  
Elkhart, IN 46514

**CANADA**

Dometic Corporation  
46 Zatonski, Unit 3  
Brantford, ON N3T 5L8  
CANADA

**SERVICE CENTER &  
DEALER LOCATION**

Visit:  
[www.eDometic.com](http://www.eDometic.com)

**DISPLAY WIRE KIT 3313470.067  
DISPLAY WIRE KIT 3313470.068**

**3313470.067 FOR RM3762  
3313470.068 FOR RM3962 AND RM1350**

**SERVICE INSTRUCTIONS**

**3313470.067  
3313470.068  
DISPLAY WIRE KIT**

**REVISION A**

Form No. 3314960.000 02/17  
(French 3314961.000\_A)  
©2017 Dometic Corporation  
LaGrange, IN 46761



**Read these instructions carefully. These  
instructions MUST stay with this product.**

# INTRODUCTION

The refrigerator will need to be removed from alcove to install the new display wire. Please exercise care during and after refrigerator is moved from the alcove during this service. Routing and securing the wire to the cooling unit frame as described within is extremely important. Do not allow wire to come in contact with parts of the cooling unit that will become hot when operating.

Use these instructions to ensure a properly installed, and properly functioning product.

Dometic Corporation reserves the right to modify appearances and specifications without notice.

# TABLE OF CONTENTS

INTRODUCTION .....	2
DOCUMENT SYMBOLS .....	2
IMPORTANT SAFETY INSTRUCTIONS .....	3
A. Recognize Safety Information .....	3
B. Understand Signal Words.....	3
C. Supplemental Directives.....	3
D. General Safety Messages .....	3
GENERAL INFORMATION.....	3
A. Scope Of Delivery.....	3
B. Required Tools.....	3
PROCEDURE.....	4
A. Installation Preparation.....	4
B. Display Wire Installation .....	4
C. Reinstall Refrigerator.....	7

# DOCUMENT SYMBOLS



Indicates additional information that is **NOT** related to physical injury.



Indicates step-by-step instructions.

# IMPORTANT SAFETY INSTRUCTIONS

This manual has safety information and instructions to help users eliminate or reduce the risk of accidents and injuries.

## A. Recognize Safety Information



This is the safety alert symbol. It is used to alert you to potential physical injury hazards. Obey all safety messages that follow this symbol to avoid possible injury or death.

## B. Understand Signal Words

A signal word will identify safety messages and property damage messages, and will indicate the degree or level of hazard seriousness.

**⚠ WARNING** indicates a hazardous situation that, if **NOT** avoided, could result in death or serious injury.

**⚠ CAUTION** indicates a hazardous situation that, if **NOT** avoided, could result in minor or moderate injury.

**NOTICE** is used to address practices **NOT** related to physical injury.

## C. Supplemental Directives



Read and follow all safety information and instructions to avoid possible injury or death.

Read and understand these instructions before [installing / using / servicing / performing maintenance] on this product.

Incorrect [installation / operation / servicing / maintaining] of this product can lead to serious injury. Follow all instructions.

The installation **MUST** comply with all applicable local or national codes, including the latest edition of the following standards:

ANSI/NFPA70, National Electrical Code (NEC)

## D. General Safety Messages

**⚠ WARNING** Failure to obey the following warnings could result in death or serious injury:

- This product **MUST** be [installed / serviced] by a qualified service technician.
- Do **NOT** modify this product beyond the scope of these service instructions. Modification (beyond these service instructions) can be extremely hazardous.

# GENERAL INFORMATION

## A. Scope Of Delivery

- (1) Service Instructions
- (1) 295460601 or 295460602 Wire Assembly, Display
- (1) 3106314.002 Permagum
- (4) 385801902 Wire Tie

## B. Required Tools

- Electric Drill
- 1/8" Drill Bit
- 1/2" Drill Bit
- #2 Phillips Screwdriver / Bit
- Flat-Bladed Screwdriver
- Wire Cutter

# PROCEDURE

## A. Installation Preparation

1. Turn refrigerator off at the control panel. Refer to unit Operating Instructions.
2. **⚠ WARNING** ELECTRICAL SHOCK HAZARD. Verify 120 Vac power is disconnected from RV. Failure to obey this warning could result in death or serious injury.
3. **NOTICE** Disconnect the positive (+) 12 Vdc terminal from supply battery. Otherwise, damage to unit could occur.
4. **⚠ WARNING** FIRE OR EXPLOSION HAZARD. Turn **OFF** LP gas supply at tank. Failure to obey this warning could result in death or serious injury.
5. **⚠ CAUTION** BURN HAZARD. Cooling unit piping may be hot. Allow time to cool before touching. Failure to obey this caution could result in injury.
6. Remove lower vent.
7. Disconnect 120 Vac power cord from receptacle at rear of refrigerator.
8. Disconnect 12 Vdc power supply at rear of refrigerator. Tape or cap ends of wiring.
9. **NOTICE** **ALWAYS** use a backup wrench when loosening or tightening LP gas connections. See (FIG. 1).  
Disconnect and cap LP gas line at rear of refrigerator.

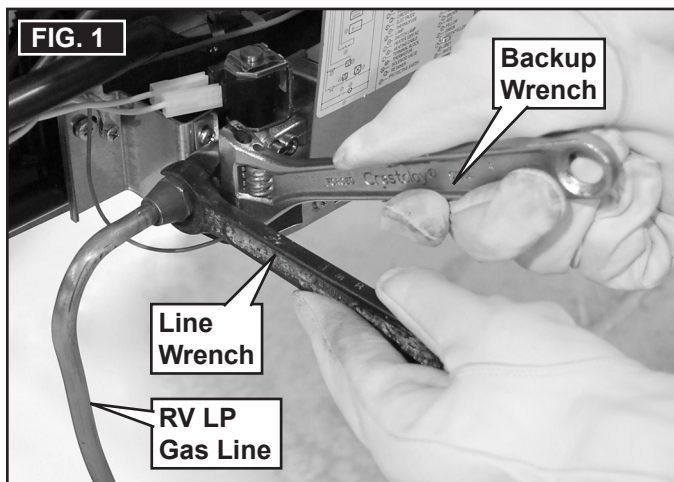

10. Remove installation screws and slide refrigerator out of alcove.

## B. Display Wire Installation

1. Locate and loosen control board cover at bottom left rear of refrigerator (right rear on RM1350). Unlock tab on both sides of cover using a flat-bladed screwdriver and swing cover up. See (FIG. 2).

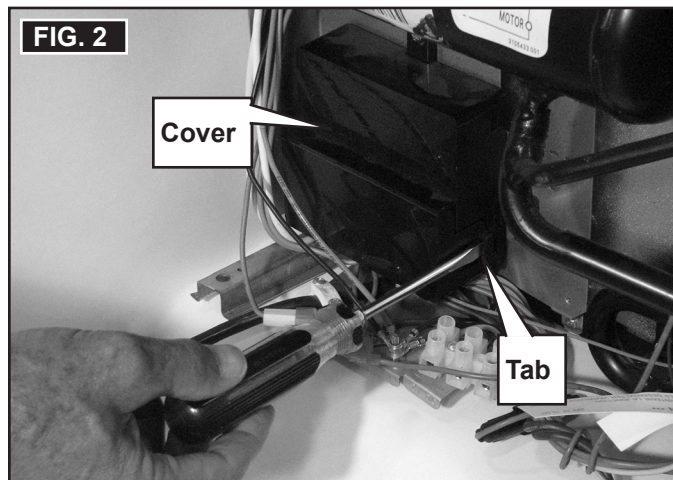

2. Disconnect the display wire from control board. See (FIG. 3).

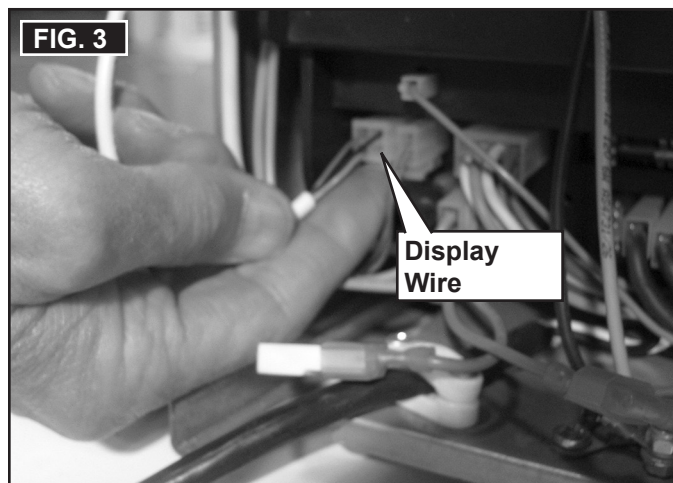

3. Cut cable as close to the back of cabinet as possible and discard. See (FIG. 4).

## PROCEDURE

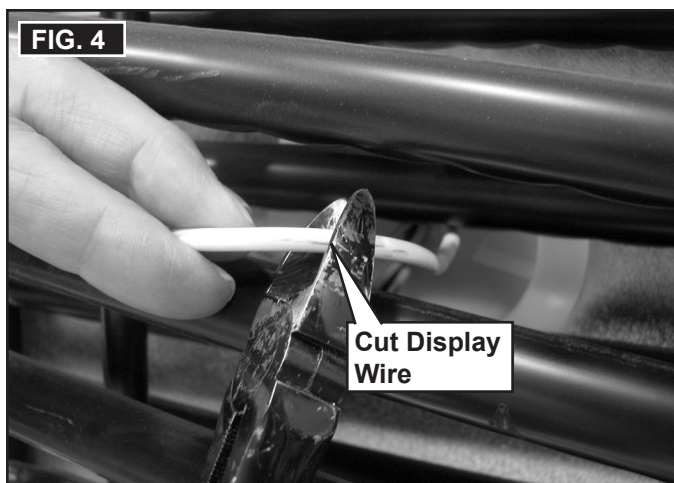

4. Remove front cover (with screws) at top of refrigerator. Save for reinstallation. See (FIG. 5).

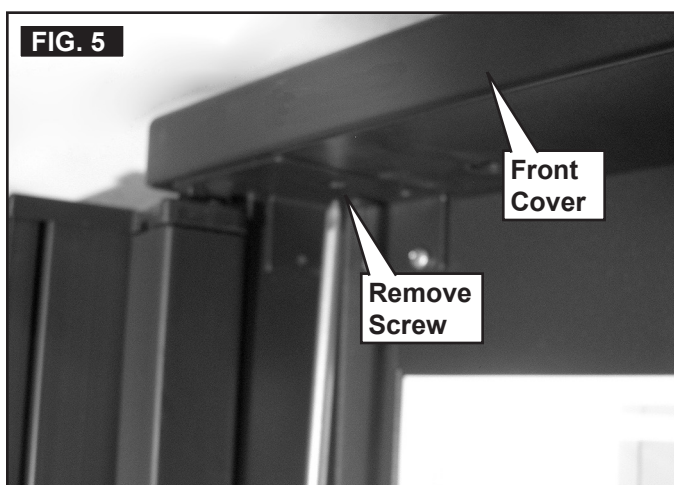

5. Disconnect display wire from display board. See (FIG. 6).

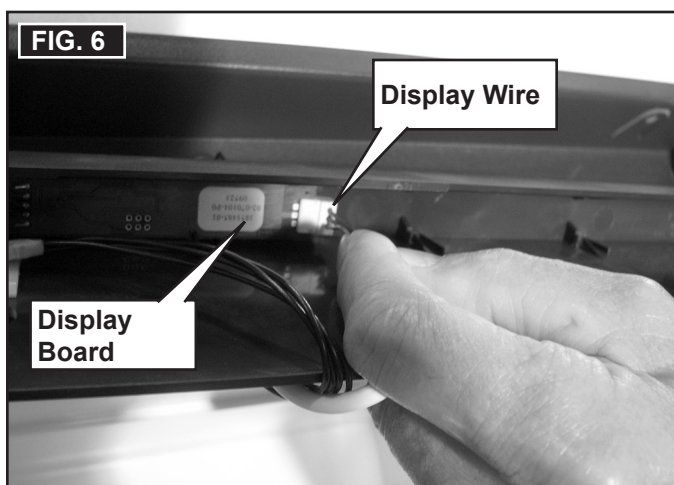

6. Remove control panel. Press down on tabs to disengage from frame. See (FIG. 7).

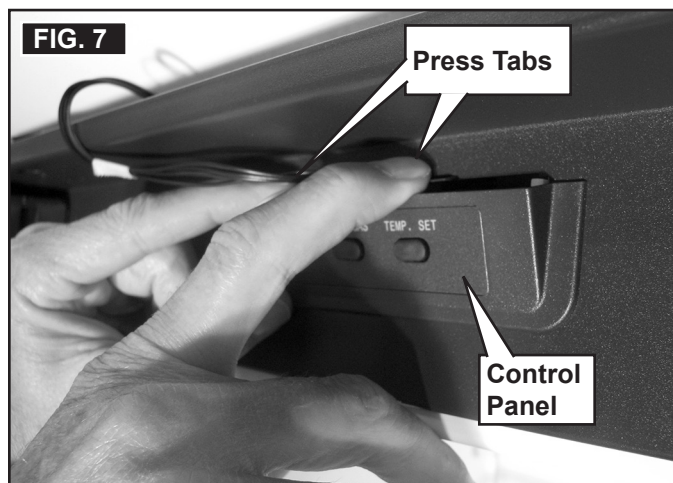

7. Cut display wire as close to wall of foaming cover as possible and discard. See (FIG. 8).

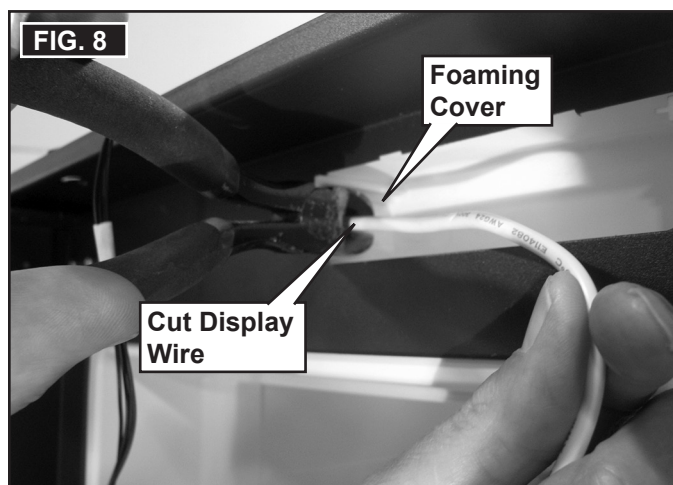

8. Drill a 1/8" pilot hole through cabinet and foaming cover. The location of this hole is critical. Viewing from the front, measure over from right side of cabinet 11-3/4" (RM3762 & RM3962) or 8-3/8" (RM1350) and 1/4" in from edge of front frame. When drilling hole make sure drill is aligned perpendicular to cabinet. Enlarge hole to 1/2". See (FIG. 9).



# PROCEDURE

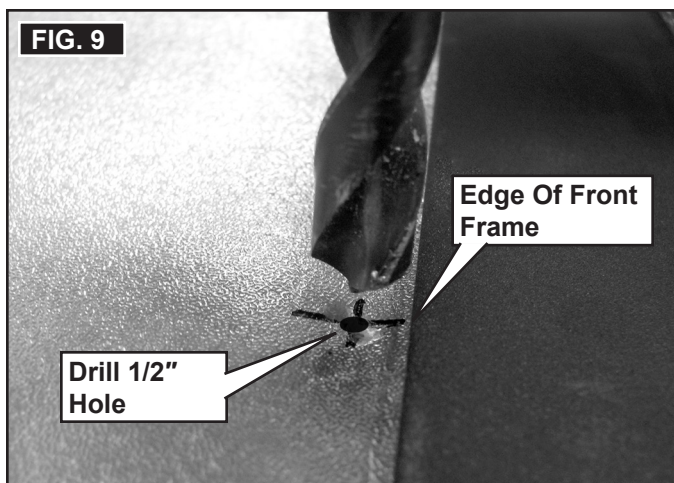

9. If necessary, smooth edge of hole with a small round file.
10. Starting at the control board, route new display wire up the back side of the refrigerator (left side RM3762 & RM3962 viewed from rear) (right side RM1350 viewed from rear) along the cooling unit frame to the top of the refrigerator. See (FIG. 10).

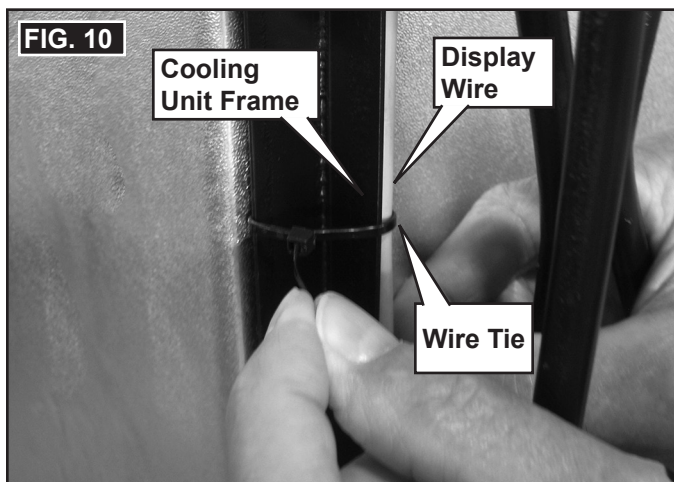

11. Connect display wire to the control board in same position as removed in step 5. See (FIG. 3).
12. Reposition all wiring as necessary and close control board cover. Be careful not to pinch any wiring.
13. Working from the top, gently pull any excess wire to the top of the refrigerator.
14. Using supplied wire ties, secure display wire to the cooling unit frame on opposite side of boiler casing (left side RM3762 & RM3962 viewed from rear) (right side RM1350 viewed from rear) and in at least three locations. See (FIG. 10).
15. Route wire through 1/2" hole and out through foaming cover. See (FIG. 11).

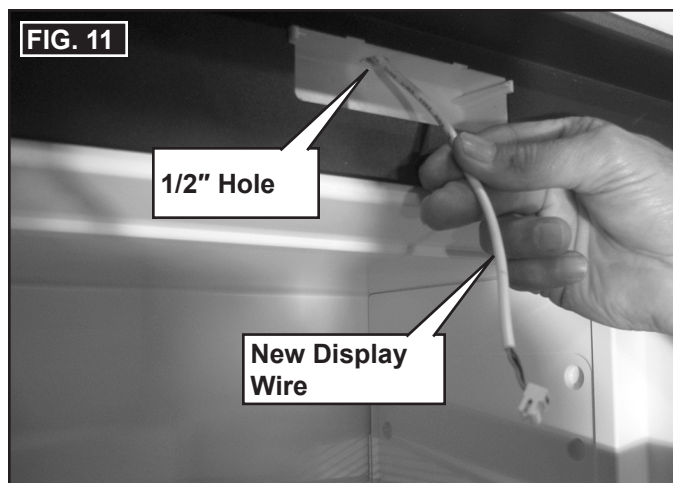

16. Using installer supplied aluminum foil tape, secure display wire to the top of refrigerator. Make sure display wire is flat and taut between hole and edge of cabinet. See (FIG. 12) & (FIG. 13).

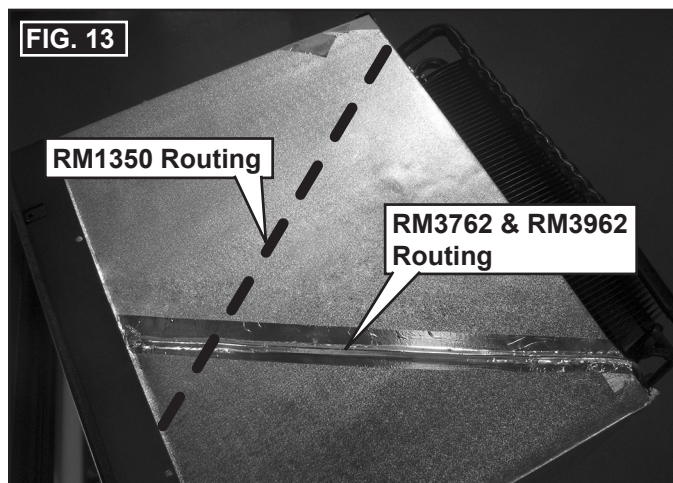
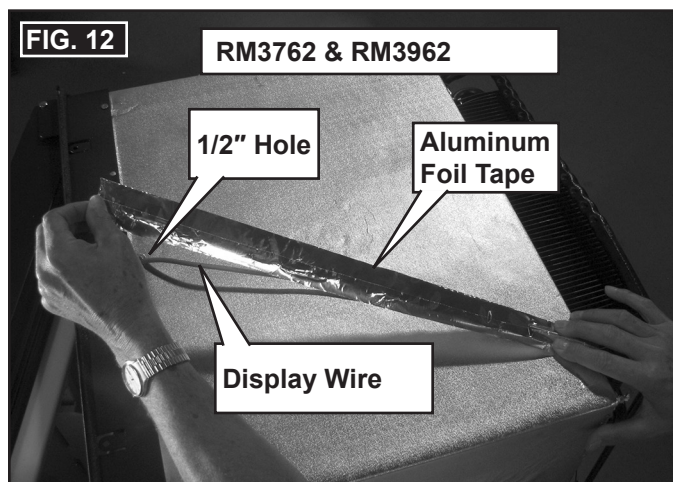

## PROCEDURE

17. Using supplied permagum, plug hole from both sides of opening so it is air tight.
18. Connect display wire to display board. See (FIG. 14).

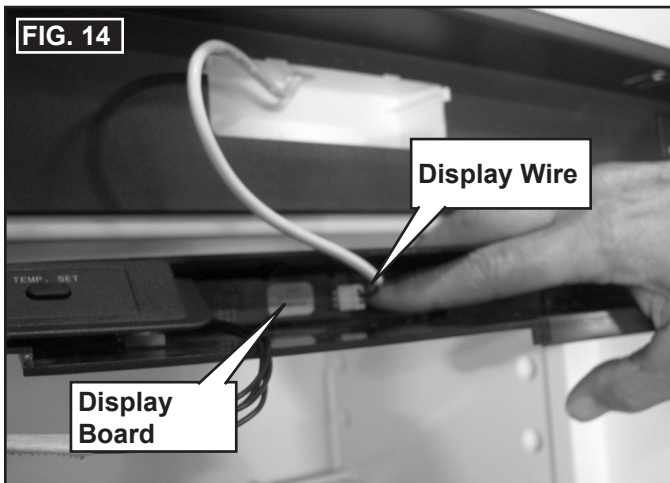

19. Reinstall control panel.
20. Route excess display wire so it does not interfere with reinstallation of front cover.
21. Reinstall front cover.



This completes the display wire installation.

### C. Reinstall Refrigerator



1. Return refrigerator to alcove and install installation screws.
2. Reconnect the 120 Vac power cord.
3. Reconnect the 12 Vdc power supply.
4. **NOTICE** ALWAYS use a backup wrench when loosening or tightening LP gas connections. See (FIG. 1).

Reconnect the LP gas line.

5. Turn on LP gas supply.
6. **WARNING** FIRE OR EXPLOSION HAZARD. NEVER use an open flame to check for gas leaks. Failure to obey this warning could result in death or serious injury.

Check LP gas line and all fittings for leaks using an approved solution. The appearance of bubbles indicates a leak and **MUST** be repaired immediately.

7. Reinstall lower vent.
8. Restore 120 Vac and 12Vdc power and check operation.