

MODEL CAL136.302 DISCHARGE TUBE VIBRATION DAMPER KIT

! CAUTION

Disconnect or turn off all electric sources before servicing.

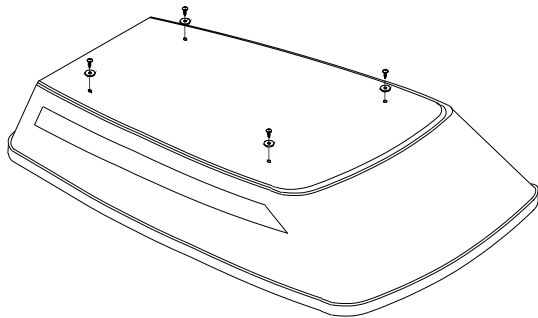

1. Remove outer cover and set aside.

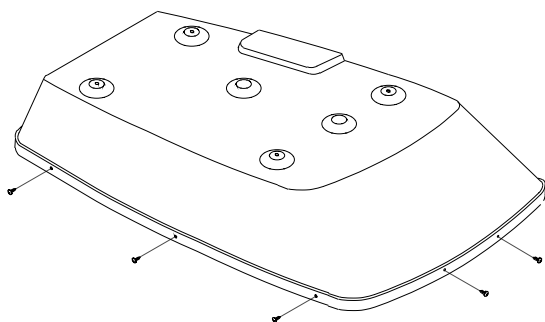

Remove Screws
around shroud base

2. Remove screws and set inner cover
aside.

3. Wrap a 17-18 cm strip of black thermal
mastic around the discharge tube next
to the downward bend.

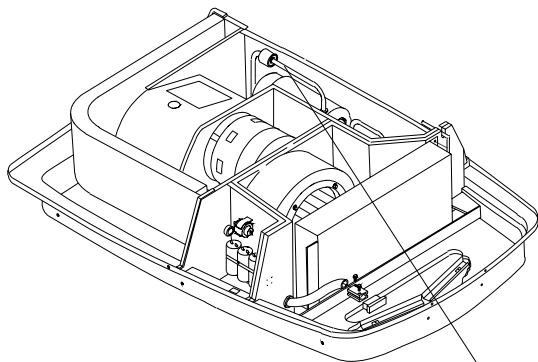

4. Reassemble both shrouds.

6. Reconnect the power.

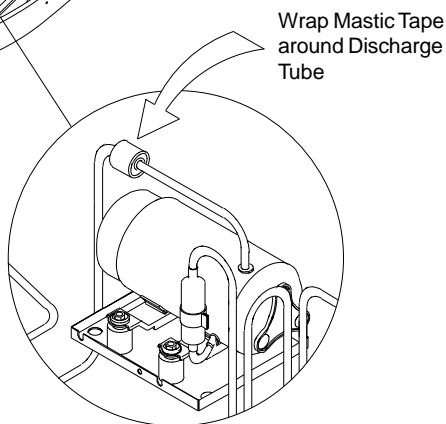

CAL 136.302

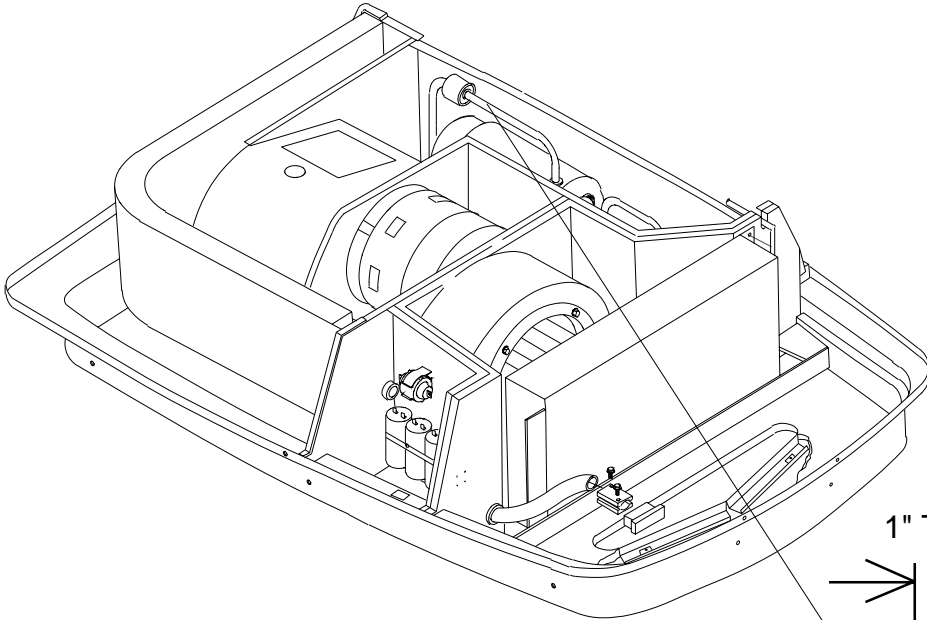

**VIBRATION DAMPER
LOCATION**

**WRAP MASTIC
TAPE AROUND
DISCHARGE TUBE**

1" TO 2"

