

DOOR REVERSAL INSTRUCTION

A step-by-step instruction describing how to change from right to left hinged doors. Locate the “Door reversing kit” as you will need these parts to complete the door reversal.

REVERSING THE HANDLES

STEP 1

Detach the handle. Use a flat blade screwdriver and gently push the two tabs away.

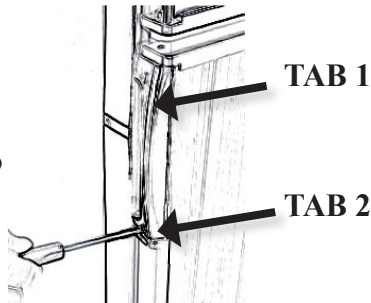

STEP 2

Remove the decoration strip by inserting a finger in the plastic profile and pull.



STEP 3

Using a screwdriver, detach the decoration strip on the opposite side.

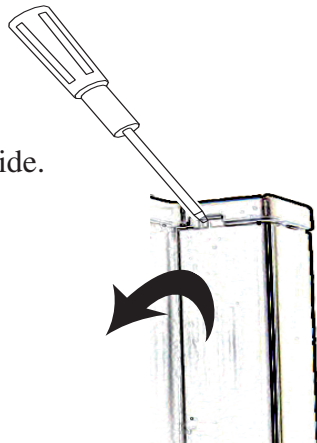

STEP 4

Replace the strip removed in step 2 with the strip removed in step 3 and the other way around.

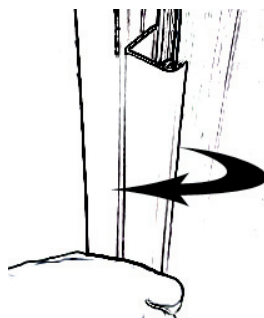

STEP 5

When mounting the handles, install the freezer door handle on the refrigerator door and vice versa.

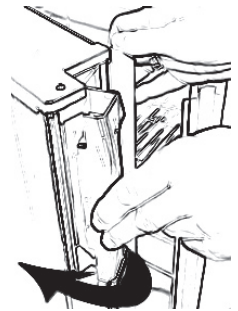

REMOVING THE UPPER DOOR

STEP 1

Open the door. To loosen the top decoration panel, remove 1 screw on each side. Gently slide the panel upwards and place it on top of the refrigerator.

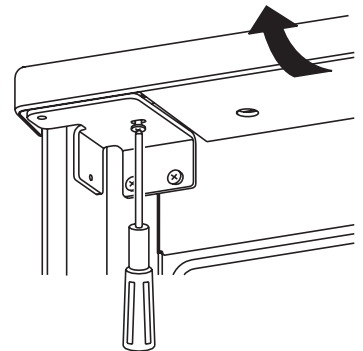

STEP 2

Close the door. Remove the upper hinge pin by using a torque wrench to hold the pin and another one to loosen the locking nut. Save the pin and locking nut. These will be reused on the opposite side when mounting the door.

STEP 3

Open the door 90°. Disengage by lifting up and off the pin and be careful not to bend the pin. To avoid scratches, place the door on some soft material.

STEP 4

Remove the plastic plug and replace it with the outermost screw and vice versa.

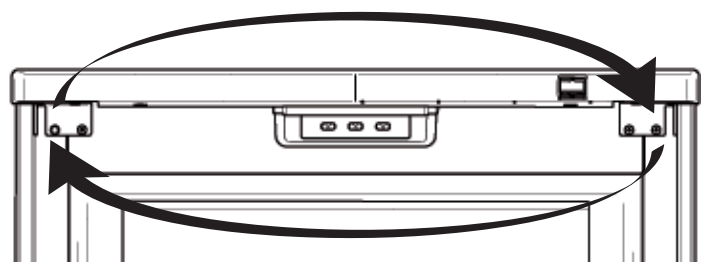

REMOVING THE LOWER DOOR

STEP 1

With the door closed, remove the hinge pin by using a torque wrench to hold the pin and another one to loosen the locking nut. Save the pin and the locking nut.

STEP 2

Open the door 90°. Disengage by lifting up and off the pin and be careful not to bend the pin. To avoid scratches, place the door on some soft material.

STEP 3

Unscrew the four screws holding the middle hinge. Remove and save the hinge.

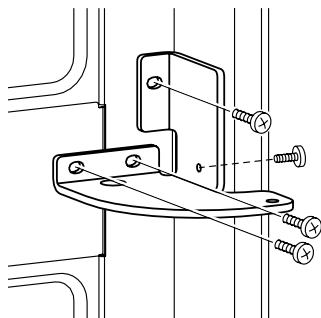

STEP 4

Remove the four screws holding the bottom hinge.

As this hinge will not be reused, it doesn't need to be saved.

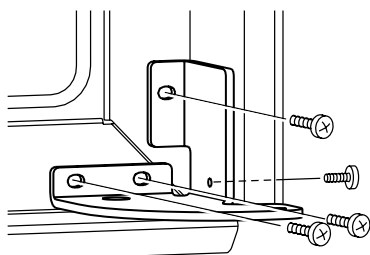

STEP 5

Remove the hinge pin and washer. Mount these on the new hinge from the "Door Reversing Kit". Use a screwdriver to fasten the pin underneath the hinge.

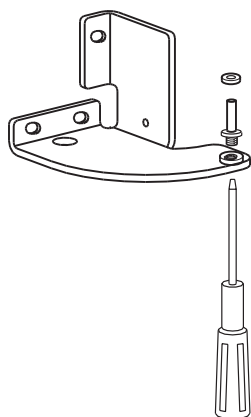

MOUNTING THE HINGES

MIDDLE HINGE

STEP 1

Remove the hole plugs from the hinge holes. For replacement plugs, see the "Door Reversing Kit". Reinstall plugs in the opposite set of holes.

STEP 2

Reuse the hinge removed in STEP 3, REMOVING THE LOWER DOOR. Fit into place and mount the hinge using 4 screws.

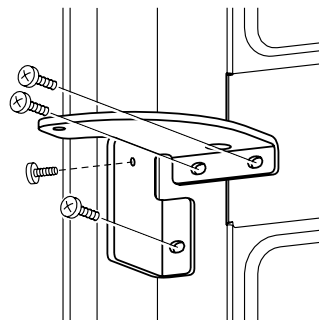

BOTTOM HINGE

STEP 1

Remove the hole plugs from the hinge holes. For replacement plugs, see the "Door Reversing Kit". Reinstall plugs in the opposite set of holes.

STEP 2

Install the new hinge (including hinge pin and washer), see STEP 5, REMOVING THE LOWER DOOR. Secure with 4 screws.

MOUNTING THE DOORS

LOWER DOOR

Put the door on the lower hinge pin and close the door. Reinstall the middle hinge pin and locking nut using two wrenches as before.

UPPER DOOR

STEP 1

Put the door on the middle door hinge pin and close the door.

STEP 2

Reinstall the upper hinge pin and locking nut using two wrenches as before.

STEP 3

Reinstall the top decoration panel. Slide into place and secure with 1 screw on each side. Do not squeeze the wires.