



CLIMATE CONTROL THERMOSTAT

EN

CT Single Zone Thermostat Service Bulletin

USA & Canada

Service Office
Dometic Corporation
1120 North Main Street
Elkhart, IN 46514

Service Center & Dealer Locations

Visit:
www.dometic.com



Failure to follow these directives could result in property damage, serious injury, or death.

Do **not** alter this product beyond what is described in this service bulletin.

This product **must** comply with all applicable local or national codes, including the latest edition of the following standards:

- ANSI/NFPA70, National Electrical Code (NEC)
- ANSI/RVIA LV, Low Voltage Systems in Conversion and Recreational Vehicles
- CSA C22.1, Parts I & II, Canadian Electrical Code

Refer to this product's installation/operation manual for additional relevant safety information.

Model	Serial Number Range	Labor Time Allowed
CT Single Zone Thermostat	3316250.000, 3316250.012, 331655.000, 331655.011	0.25 hr.

Required Tools

Screw: #6 x 1.00PHCR or a pointed implement

Symptoms:

1. The thermostat fails to consistently maintain the RV's cabin temperature at the owner's set points.
2. The thermostat does not respond to changes in settings.
3. The thermostat switches between modes without being touched.

Cause:

The PCB spade connectors are not making sufficient contact with the conductive foam.

Remedy:

See the procedure below.

1.1 Inspection

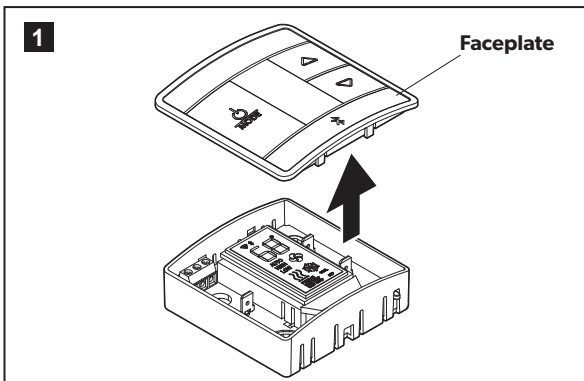

- Remove the touch panel faceplate.
- Inspect the conductive foam.

1.2 Repairing damaged foam

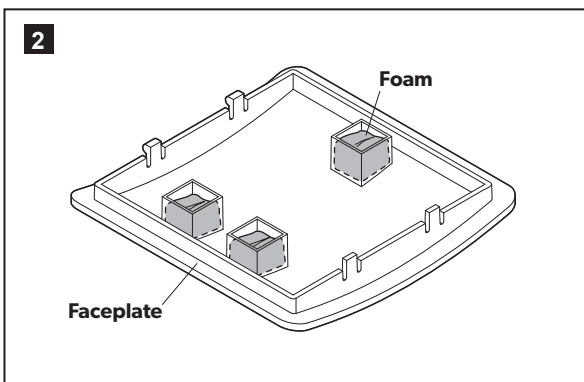

- Remove any distorted or deformed foam.

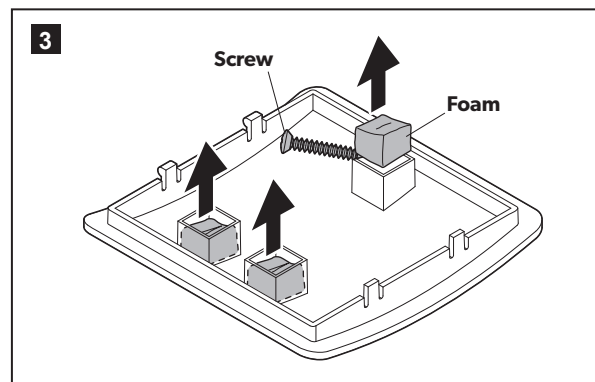

- Use a pointed, but not sharp, object to carefully pry out the distorted foam from its cavity without damaging the foam or the cavity.

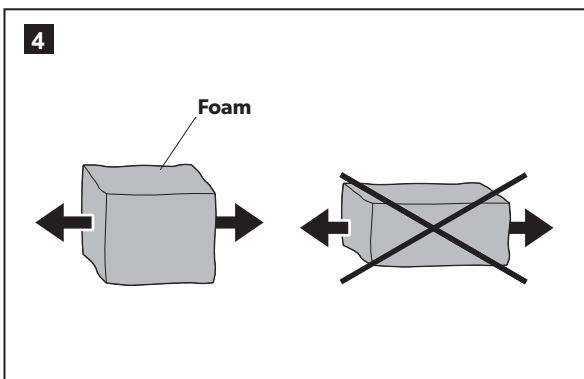

- Mold the foam back to its previous shape.

i Do **not** overstretch the foam.

1.3 Re-install reconditioned foam

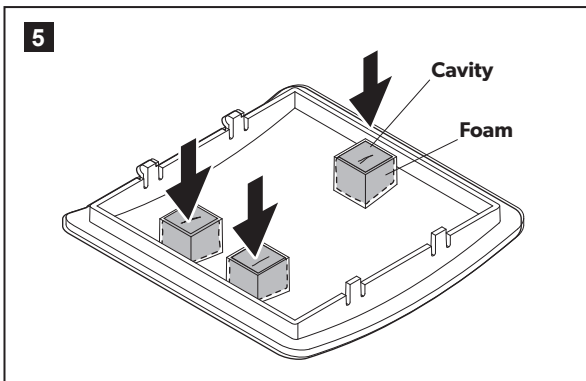

- Re-insert the foam into its cavity by hand. Make sure that the top of the foam is flush with the top of the cavity.

1.4 Re-assembling the CTT

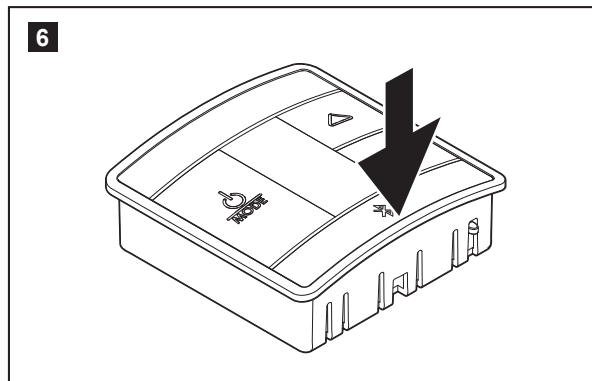

- Re-assemble the unit.

1.5 Testing the CTT

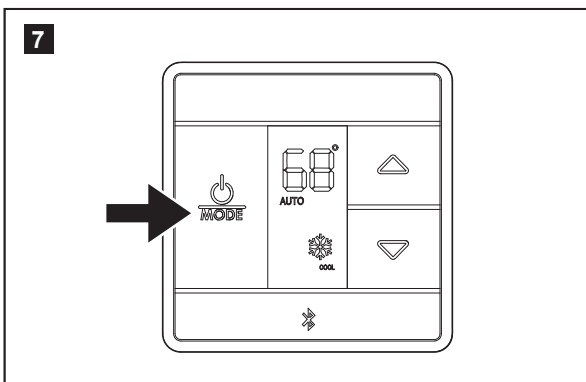

- Test the CTT for accuracy.

1.6 Troubleshooting

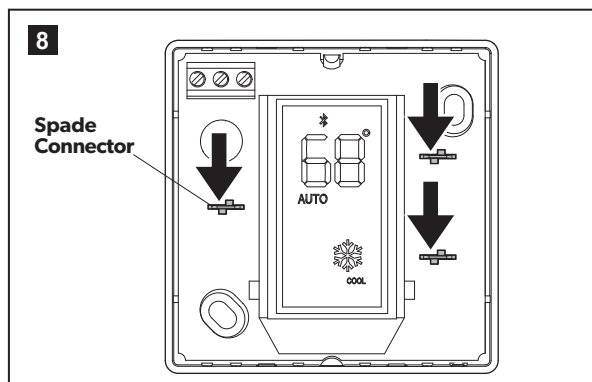

- If the unit does not respond, remove the touch panel faceplate and operate the spade connectors directly by finger to control the unit.