



CLIMATE CONTROL RETURN AIR GRILLE

EN

Return Air Grille Service Bulletin

USA & Canada

Service Office
Dometic Corporation
1120 North Main Street
Elkhart, IN 46514

Service Center & Dealer Locations

Visit:
www.dometic.com

Read these instructions carefully.

| Model | Serial Number Range |
|---------------------------|--------------------------|
| Dometic Return Air Grille | 3315910.012, 3315930.010 |

Dometic return air grilles have an issue with the foam barrier that separates the discharge air from the return air for the A/C unit. A non-conforming foam barrier creates a gap between the grille shell and the ceiling template. This gap results in a loss of A/C efficiency, with significantly lower air flow delivered to the ducted vents, and has the possibility of freezing the evaporator coil in hot, humid environments. To solve the problem, the appropriate foam must be installed on top of the non-conforming foam to properly seal the gap between the grille shell and the ceiling template.

⚠ WARNING Turn OFF power to the A/C at the circuit breaker. Failure to obey this warning could result in death or serious injury.

⚠ CAUTION Do **not** insert hands into the return air space unless the A/C blower has stopped turning. Failure to obey this caution could result in serious injury.

1 IDENTIFYING THE FOAM ISSUE

1.1 Removing the grille

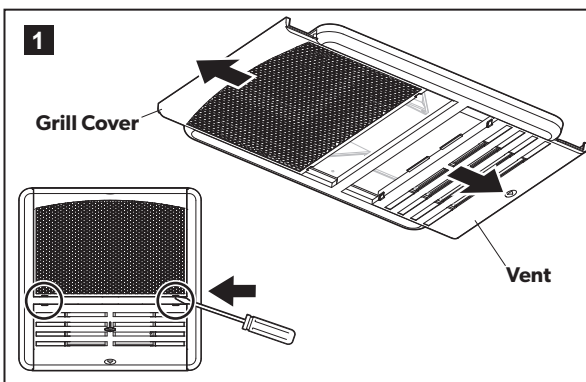

- Open the grille cover and vent using a flathead screw driver.
- Slide the grille cover and vent out and away from the grille shell.

1.2 Locating the foam strip

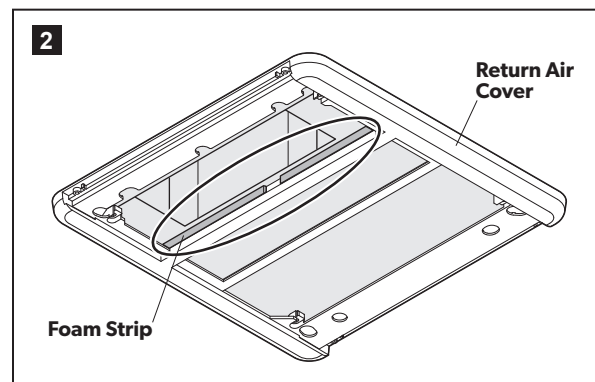

- Locate the foam strip as shown in Figure 2.

1.3 Assessing the foam installation

No gap

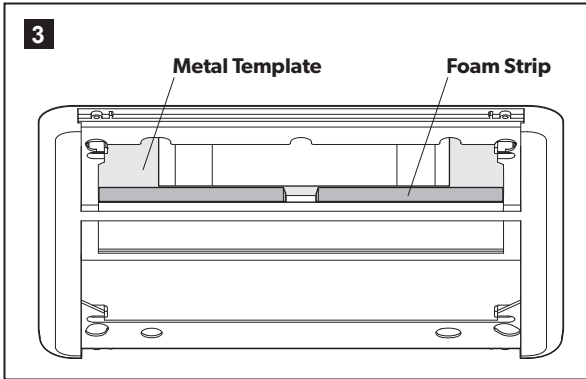

i If there is no gap present, the unit is in compliance.

Gap present

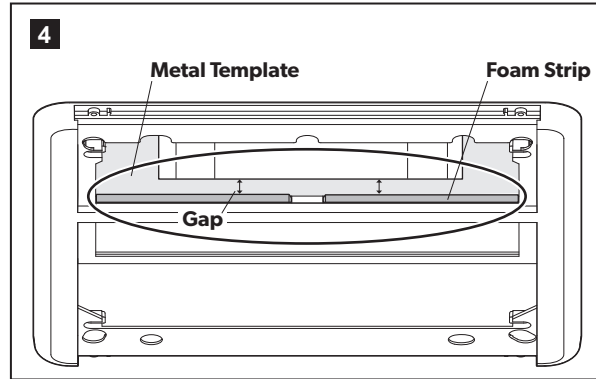

i If a gap is present between the foam and metal ceiling template, the foam installation must be reworked. Refer to section "2 Reworking the foam installation."

2 REWORKING THE FOAM INSTALLATION

2.1 Removing the cover

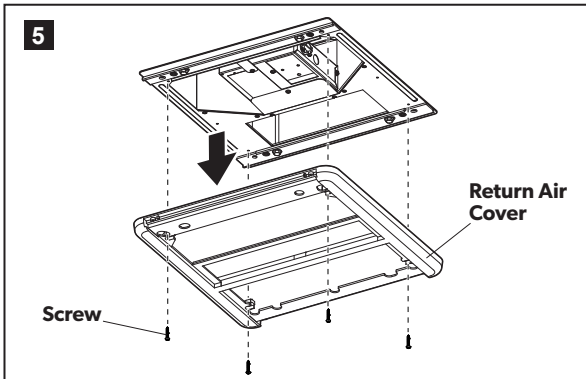

- Remove the air filter cover and quick-cool vent from the grille to access the screws.
- Remove the small screws holding the grille to the ceiling or ceiling template.

2.2 Installing the new foam barrier

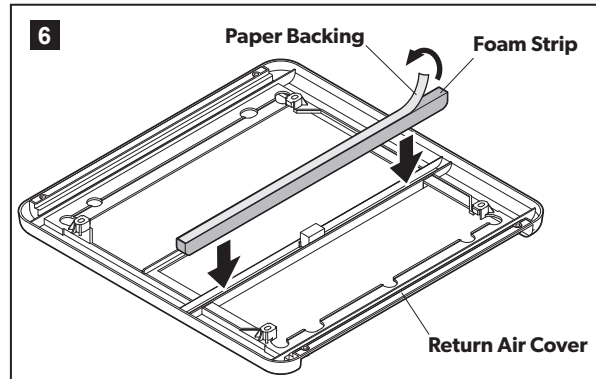

i Only use the foam specified (service kit part number 31375). This Foam is UL94V-0 rated for use in HVAC systems.

- Cut the foam to a length of 16.75".
- Peel back the paper to expose the adhesive and apply the foam directly to the top of the existing foam barrier.
- Reinstall the grille shell. There should be no gaps between the grille shell and the ceiling template.

i The remaining 15" of foam can be used on another return air grille. Two cut off pieces will be needed to make up the 16.75" needed for the rework.