



# CLIMATE CONTROL THERMOSTAT

EN

## CT Single Zone Thermostat Information Notice

### USA & Canada

Service Office  
Dometic Corporation  
1120 North Main Street  
Elkhart, IN 46514

### Service Center & Dealer Locations

**Visit:**  
[www.dometic.com](http://www.dometic.com)



Failure to follow these directives could result in property damage, serious injury, or death.

Do **not** alter this product beyond what is described in this Information Notice.

This product **must** comply with all applicable local or national codes, including the latest edition of the following standards:

- ANSI/NFPA70, National Electrical Code (NEC)
- CSA C22.1, Parts I & II, Canadian Electrical Code
- ANSI/RVIA LV, Low Voltage Systems in Conversion and Recreational Vehicles

Refer to this product's installation/operation manual for additional relevant safety information.

Model	Serial Number Range	Labor Time Allowed
CT Single Zone Thermostat	3316250.000, 3316250.012, 331655.000, 331655.011	0.15 hr.

**Symptoms:** Current production CTTs are changing temperature, mode and units after installation. Some of these failures are occurring instantly, while others are occurring after the CTT has been in use for a period of time.

**Cause:** Failures have been determined to come from intermittent contact between the conductive foam inside the cavity of the CTT and the spade connectors on the board. A service kit is provided with the foam pre-installed on the faceplate, replacing the current faceplate in order to resume the proper function of the CTT.

**Remedy:** See the procedure below to replace the faceplate.

### 1.1 Removing the faceplate

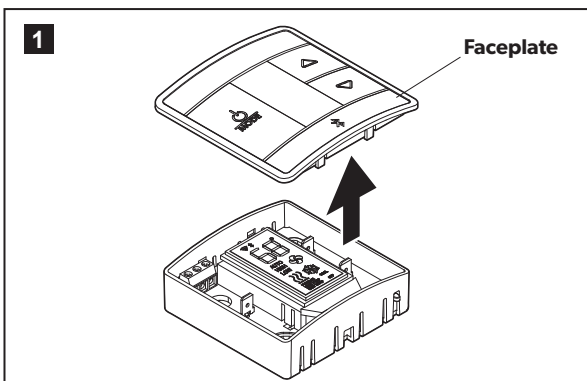

- Power off the unit and remove the touch panel faceplate.

### 1.2 Re-assembling the CTT

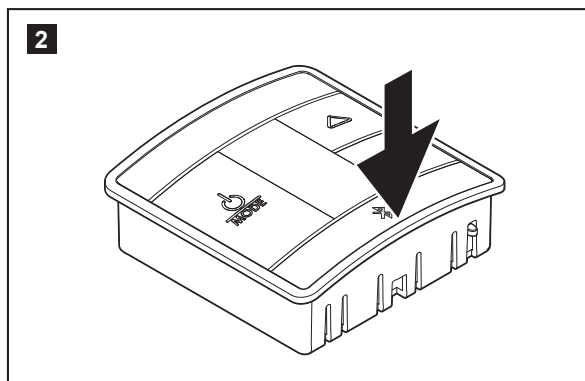

- Re-assemble the unit with the new faceplate.
- Power on the unit.

### 1.3 Testing the CTT

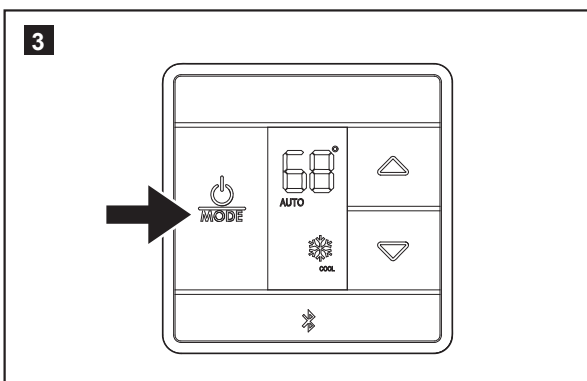

- Test the CTT for accuracy.
- Function will resume.