

Symptom: Condensation infiltrating into living space from plenum.

Cause: During the installation torque process, the pan can be stressed in a way that would let water wick through the clinch nuts and supporting brackets during heavy rains.

Remedy: Seal the clinch nuts and supporting brackets using self-leveling adhesive.

Cause: When the pan gasket compresses against the roof, during heavy rain, water drains through the holes in the pan that are provided for the non-ducted application.

Remedy: Replace the gasket and torque the pan to the proper specifications. As an added protection, seal the holes provided for the non-ducted application.

Model	Serial # Range	Labor Time Allowed
FR 3		.7 Hour
Dynamax		.7 Hour

Atwood Mobile Products Contact Information	
Technical Service #	866-869-3118
E-mail Address	service@atwoodmobile.com



Read these instructions carefully. These instructions **MUST** stay with this product.

Dometic Corporation reserves the right to modify product appearances and specifications without notice.

REPAIR INSTRUCTIONS

- Remove the inside plenum (airbox).
- Unbolt the Air Conditioner from the roof.
- While on the roof, turn the Air Conditioner so that the gasket on the bottom is facing up.

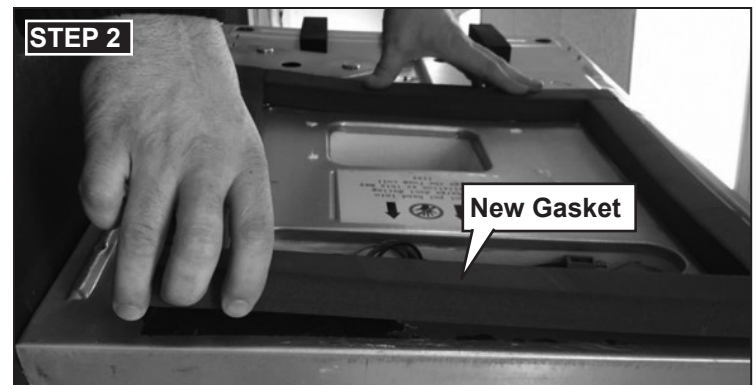

- Scrape off the existing gasket.
- Press the new Dometic gasket (part number 3100247.000) into place.

REVISION A

Form No. 3316793.000 11/16
(French 3316811.000_A)
©2016 Dometic Corporation
LaGrange, IN 46761

USA

SERVICE OFFICE
Dometic Corporation
1120 North Main Street
Elkhart, IN 46514

CANADA

Dometic Corporation
46 Zatonski, Unit 3
Brantford, ON N3T 5L8
CANADA

SERVICE CENTER & DEALER LOCATIONS

Visit:
www.eDometic.com

REPAIR INSTRUCTIONS

i For ducted units (part numbers 15027, 15028, 15032, 15033) continue with Step 3. For all other units, skip to Step 6.

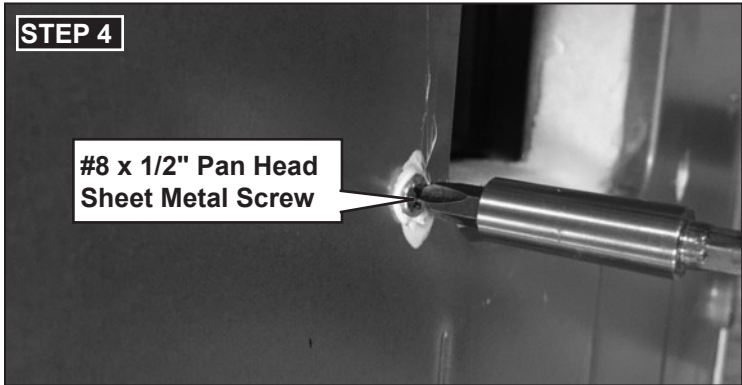

- Locate the four holes near the air outlet on the underside of the Air Conditioner and apply 1021 sealant through and around the holes.

- Insert four #8 x 1/2" long Pan Head sheet metal screws through the sealant and into the four holes.

i The four holes are provided for non-ducted applications and need to be sealed for ducted units.



- Cover the four screws with 1021 sealant.

- Roll the Air Conditioner back into place with the bottom facing down.
- Remove the four screws from the top of the shroud.

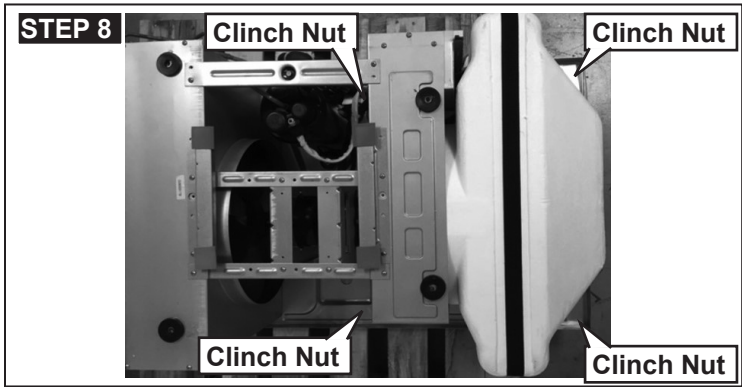

- Lift the front end of the shroud, then remove it from the unit.

- Locate the four clinch nuts and brackets, at each corner of the gasket area, that bolt the Air Conditioner to the roof.

REPAIR INSTRUCTIONS

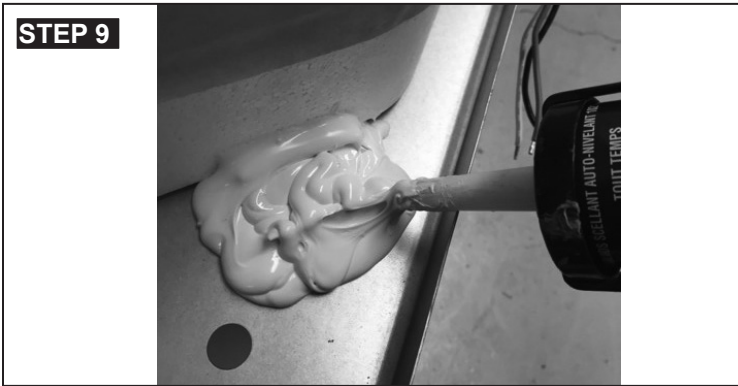

- Completely seal all four nuts and brackets until no metal is exposed.

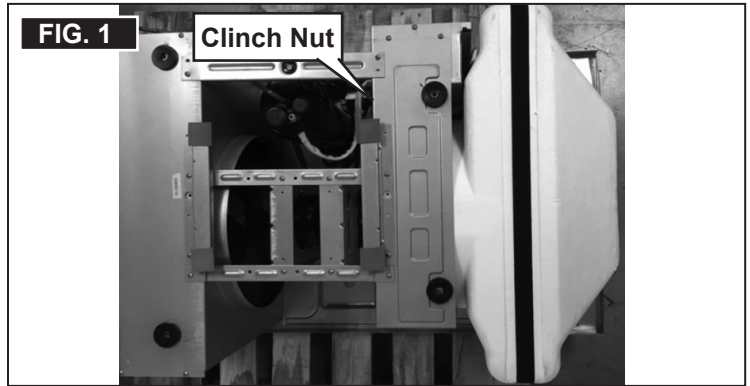

-  Use care working around the compressor and lines when sealing the clinch-nut in this location

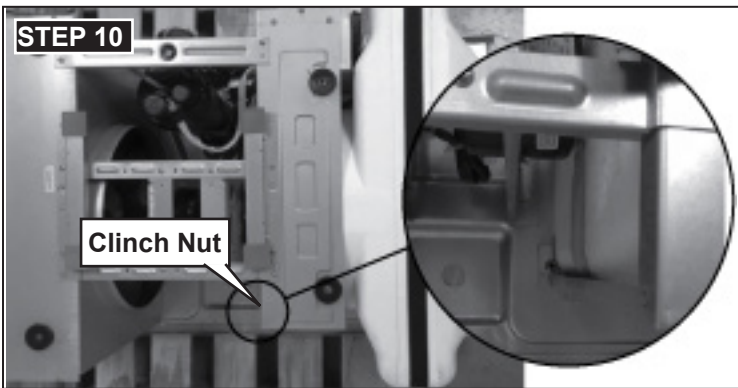

To completely seal the clinch-nut and bracket in this location:

- Remove the two screws holding the large bracket to the base.
- Pull the bracket out of the way.



- Push the bracket back into place.
- Use the previously removed screws to re-attach the bracket. Do not overtighten the screws.

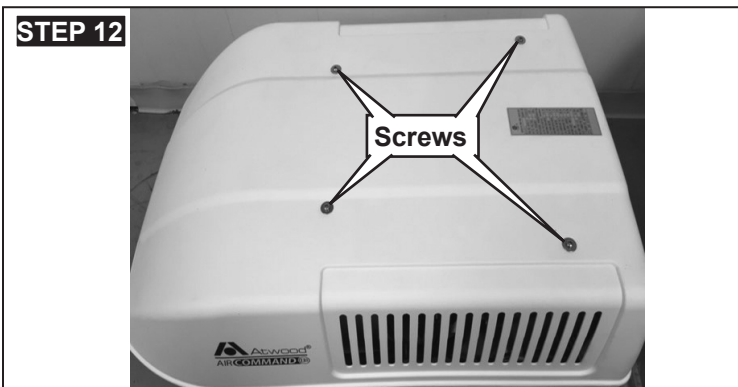

- Once all locations have been properly sealed, re-attach the shroud by replacing and tightening the four screws removed in STEP 6.

NOTICE Upon re-installation, torque the four installation bolts to 50 in.-lb. maximum. Torque in an "x" pattern for an even seal.

- Re-bolt the Air Conditioner to the roof using the recommended torque specifications.
- Re-attach the inside plenum (airbox).

GENERAL INFORMATION

REQUIRED TOOLS AND MATERIALS

(4) #8 x 1/2" long, Pan Head Sheet Metal Screw	1/2" Socket
Dometic Gasket Number 3100247.000	1021 Alpha Self-Leveling Sealant (color optional)

CHECKLIST

CHECK	INITIALS
Replace Gasket	<input type="checkbox"/> _____
Seal Air Outlet Holes (part numbers 15027, 15028, 15032, 15033)	<input type="checkbox"/> _____
Seal Clinch Nuts and Brackets	<input type="checkbox"/> _____