



LITERATURE NUMBER MPD 53401

DOMETIC CORPORATION  
1120 North Main Street, Elkhart, IN 46514  
Please Visit: WWW.DOMETIC.COM

## THERMOSTAT REPLACEMENT

Revision A, 10/19/18

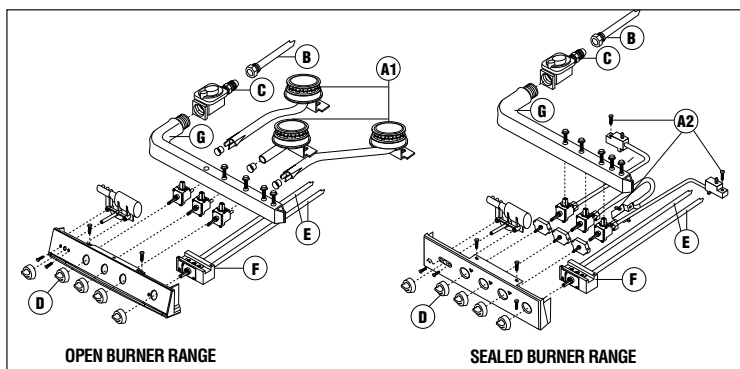

For complete range &amp; cooktop instructions consult MPD 56282.

### ⚠ WARNING EXPLOSION OR FIRE

- Improper installation, adjustment, alteration, service or maintenance can cause injury or property damage.
- Refer to MPD 56282 for complete instructions.
- For assistance or additional information consult Dometic Consumer Service Department, a qualified installer, service agency or gas supplier.
- Follow directions exactly for proper installation, adjustment, service and maintenance.

### ⚠ WARNING EXPLOSION OR FIRE

- Gas supply must be turned off and all controls set in OFF position when removing or replacing any range part.

**NOTE:** The thermostat is difficult to replace. Check and eliminate safety valve, pilot orifice and oven burner as the source of problem before deciding to change the thermostat.

continued backside



LITERATURE NUMBER MPD 53401

DOMETIC CORPORATION  
1120 North Main Street, Elkhart, IN 46514  
Please Visit: WWW.DOMETIC.COM

## THERMOSTAT REPLACEMENT

Revision A, 10/19/18

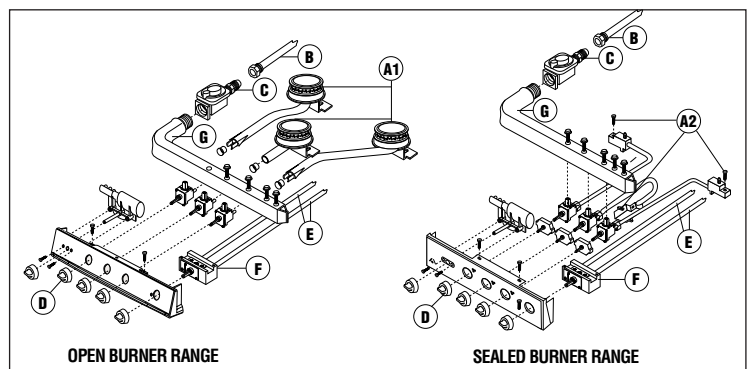

For complete range &amp; cooktop instructions consult MPD 56282.

### ⚠ WARNING EXPLOSION OR FIRE

- Improper installation, adjustment, alteration, service or maintenance can cause injury or property damage.
- Refer to MPD 56282 for complete instructions.
- For assistance or additional information consult Dometic Consumer Service Department, a qualified installer, service agency or gas supplier.
- Follow directions exactly for proper installation, adjustment, service and maintenance.

### ⚠ WARNING EXPLOSION OR FIRE

- Gas supply must be turned off and all controls set in OFF position when removing or replacing any range part.

**NOTE:** The thermostat is difficult to replace. Check and eliminate safety valve, pilot orifice and oven burner as the source of problem before deciding to change the thermostat.

continued backside



LITERATURE NUMBER MPD 53401

DOMETIC CORPORATION  
1120 North Main Street, Elkhart, IN 46514  
Please Visit: WWW.DOMETIC.COM

## THERMOSTAT REPLACEMENT

Revision A, 10/19/18

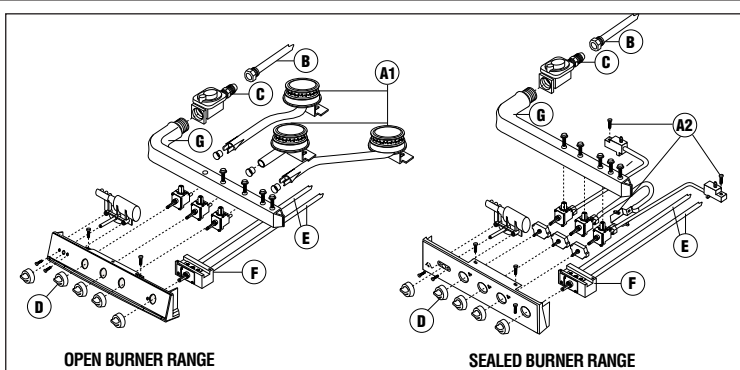

For complete range &amp; cooktop instructions consult MPD 56282.

### ⚠ WARNING EXPLOSION OR FIRE

- Improper installation, adjustment, alteration, service or maintenance can cause injury or property damage.
- Refer to MPD 56282 for complete instructions.
- For assistance or additional information consult Dometic Consumer Service Department, a qualified installer, service agency or gas supplier.
- Follow directions exactly for proper installation, adjustment, service and maintenance.

### ⚠ WARNING EXPLOSION OR FIRE

- Gas supply must be turned off and all controls set in OFF position when removing or replacing any range part.

**NOTE:** The thermostat is difficult to replace. Check and eliminate safety valve, pilot orifice and oven burner as the source of problem before deciding to change the thermostat.

continued backside



LITERATURE NUMBER MPD 53401

DOMETIC CORPORATION  
1120 North Main Street, Elkhart, IN 46514  
Please Visit: WWW.DOMETIC.COM

## THERMOSTAT REPLACEMENT

Revision A, 10/19/18

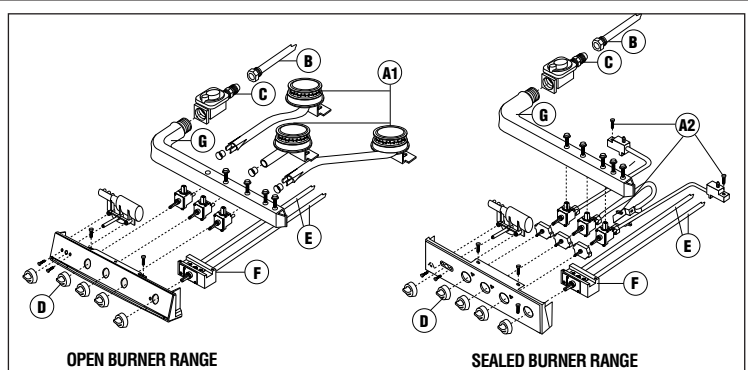

For complete range &amp; cooktop instructions consult MPD 56282.

### ⚠ WARNING EXPLOSION OR FIRE

- Improper installation, adjustment, alteration, service or maintenance can cause injury or property damage.
- Refer to MPD 56282 for complete instructions.
- For assistance or additional information consult Dometic Consumer Service Department, a qualified installer, service agency or gas supplier.
- Follow directions exactly for proper installation, adjustment, service and maintenance.

### ⚠ WARNING EXPLOSION OR FIRE

- Gas supply must be turned off and all controls set in OFF position when removing or replacing any range part.

**NOTE:** The thermostat is difficult to replace. Check and eliminate safety valve, pilot orifice and oven burner as the source of problem before deciding to change the thermostat.

continued backside

#### REMOVAL PROCEDURE-

1. Set oven control to OFF.
2. Turn off gas supply using appliance shut off valve or valve on gas bottles.
3. a. **OPEN BURNER** - remove range top and all top burners A-1  
b. **SEALED BURNER** - Prop top up and remove burner tube mounting screws A-2.

Note: On models with range pilot (top lighter), remove two screws which secure pilot assembly to burner box.

4. Disconnect gas supply -B from the brass fitting connection -C on the regulator.

#### **CAUTION** **PRODUCT DAMAGE**

- Use two wrenches when removing and installing gas line from the regulator fitting. Use one wrench on gas line fitting and one on regulator fitting.

5. Remove all screws securing range to cabinet or wall.
6. Slide range forward 5 inches in the cabinet.
7. Remove all control knobs-D.
8. Remove both aluminum gas lines-E to thermostat-F.
9. At rear wall of oven interior, just under flue opening, remove thermostat's capillary tube from tension clip.
10. Feed capillary tube through entry hole in oven's rear wall up into the burner box.
11. Remove the four screws holding manifold to burner box and remove manifold-G.
12. Remove bolts securing thermostat to manifold and remove thermostat -F.

#### INSTALLATION PROCEDURE-

1. Connect new thermostat to manifold, torque to 20-25 inch pounds.
2. Reinstall manifold to burner box.
3. Carefully feed capillary tube back into oven and replace in tension clip so that it is straight, horizontal and directly centered beneath the flue opening.

Note: If capillary tube becomes kinked or out of place it will not function properly. Any damage to capillary tube requires replacing whole thermostat. Individual parts of thermostat cannot be repaired or replaced.

4. Continue reassembling range by following the **REMOVAL PROCEDURES** in reverse order.
5. After reconnecting both aluminum gas supply lines to manifold, replace all top burners and/or burner tubes.
6. Check all connections for gas leaks using a non-corrosive leak detection fluid. Do not use a soap and water solution. Leak testing in excess of 14 inches water column (1/2 psi) of air pressure will invalidate warranty.
7. To verify safety valve connection is properly seated and will not leak:
  - a. Remove oven heat shield (if supplied), bottom oven shelf and rack.
  - b. Turn gas supply on.
  - c. Set oven control to 400°F.
  - d. Apply a non-corrosive leak detection fluid to safety valve gas input line connection and check for leaks.
  - e. When certain connection is properly sealed and will not leak, turn oven control to OFF.
  - f. If there are no leaks reinstall heat shield (if supplied), bottom oven shelf and rack.

#### REMOVAL PROCEDURE-

1. Set oven control to OFF.
2. Turn off gas supply using appliance shut off valve or valve on gas bottles.
3. a. **OPEN BURNER** - remove range top and all top burners A-1  
b. **SEALED BURNER** - Prop top up and remove burner tube mounting screws A-2.

Note: On models with range pilot (top lighter), remove two screws which secure pilot assembly to burner box.

4. Disconnect gas supply -B from the brass fitting connection -C on the regulator.

#### **CAUTION** **PRODUCT DAMAGE**

- Use two wrenches when removing and installing gas line from the regulator fitting. Use one wrench on gas line fitting and one on regulator fitting.

5. Remove all screws securing range to cabinet or wall.
6. Slide range forward 5 inches in the cabinet.
7. Remove all control knobs-D.
8. Remove both aluminum gas lines-E to thermostat-F.
9. At rear wall of oven interior, just under flue opening, remove thermostat's capillary tube from tension clip.
10. Feed capillary tube through entry hole in oven's rear wall up into the burner box.
11. Remove the four screws holding manifold to burner box and remove manifold-G.
12. Remove bolts securing thermostat to manifold and remove thermostat -F.

#### INSTALLATION PROCEDURE-

1. Connect new thermostat to manifold, torque to 20-25 inch pounds.
2. Reinstall manifold to burner box.
3. Carefully feed capillary tube back into oven and replace in tension clip so that it is straight, horizontal and directly centered beneath the flue opening.

Note: If capillary tube becomes kinked or out of place it will not function properly. Any damage to capillary tube requires replacing whole thermostat. Individual parts of thermostat cannot be repaired or replaced.

4. Continue reassembling range by following the **REMOVAL PROCEDURES** in reverse order.
5. After reconnecting both aluminum gas supply lines to manifold, replace all top burners and/or burner tubes.
6. Check all connections for gas leaks using a non-corrosive leak detection fluid. Do not use a soap and water solution. Leak testing in excess of 14 inches water column (1/2 psi) of air pressure will invalidate warranty.
7. To verify safety valve connection is properly seated and will not leak:
  - a. Remove oven heat shield (if supplied), bottom oven shelf and rack.
  - b. Turn gas supply on.
  - c. Set oven control to 400°F.
  - d. Apply a non-corrosive leak detection fluid to safety valve gas input line connection and check for leaks.
  - e. When certain connection is properly sealed and will not leak, turn oven control to OFF.
  - f. If there are no leaks reinstall heat shield (if supplied), bottom oven shelf and rack.

#### REMOVAL PROCEDURE-

1. Set oven control to OFF.
2. Turn off gas supply using appliance shut off valve or valve on gas bottles.
3. a. **OPEN BURNER** - remove range top and all top burners A-1  
b. **SEALED BURNER** - Prop top up and remove burner tube mounting screws A-2.

Note: On models with range pilot (top lighter), remove two screws which secure pilot assembly to burner box.

4. Disconnect gas supply -B from the brass fitting connection -C on the regulator.

#### **CAUTION** **PRODUCT DAMAGE**

- Use two wrenches when removing and installing gas line from the regulator fitting. Use one wrench on gas line fitting and one on regulator fitting.

5. Remove all screws securing range to cabinet or wall.
6. Slide range forward 5 inches in the cabinet.
7. Remove all control knobs-D.
8. Remove both aluminum gas lines-E to thermostat-F.
9. At rear wall of oven interior, just under flue opening, remove thermostat's capillary tube from tension clip.
10. Feed capillary tube through entry hole in oven's rear wall up into the burner box.
11. Remove the four screws holding manifold to burner box and remove manifold-G.
12. Remove bolts securing thermostat to manifold and remove thermostat -F.

#### INSTALLATION PROCEDURE-

1. Connect new thermostat to manifold, torque to 20-25 inch pounds.
2. Reinstall manifold to burner box.
3. Carefully feed capillary tube back into oven and replace in tension clip so that it is straight, horizontal and directly centered beneath the flue opening.

Note: If capillary tube becomes kinked or out of place it will not function properly. Any damage to capillary tube requires replacing whole thermostat. Individual parts of thermostat cannot be repaired or replaced.

4. Continue reassembling range by following the **REMOVAL PROCEDURES** in reverse order.
5. After reconnecting both aluminum gas supply lines to manifold, replace all top burners and/or burner tubes.
6. Check all connections for gas leaks using a non-corrosive leak detection fluid. Do not use a soap and water solution. Leak testing in excess of 14 inches water column (1/2 psi) of air pressure will invalidate warranty.
7. To verify safety valve connection is properly seated and will not leak:
  - a. Remove oven heat shield (if supplied), bottom oven shelf and rack.
  - b. Turn gas supply on.
  - c. Set oven control to 400°F.
  - d. Apply a non-corrosive leak detection fluid to safety valve gas input line connection and check for leaks.
  - e. When certain connection is properly sealed and will not leak, turn oven control to OFF.
  - f. If there are no leaks reinstall heat shield (if supplied), bottom oven shelf and rack.

#### REMOVAL PROCEDURE-

1. Set oven control to OFF.
2. Turn off gas supply using appliance shut off valve or valve on gas bottles.
3. a. **OPEN BURNER** - remove range top and all top burners A-1  
b. **SEALED BURNER** - Prop top up and remove burner tube mounting screws A-2.

Note: On models with range pilot (top lighter), remove two screws which secure pilot assembly to burner box.

4. Disconnect gas supply -B from the brass fitting connection -C on the regulator.

#### **CAUTION** **PRODUCT DAMAGE**

- Use two wrenches when removing and installing gas line from the regulator fitting. Use one wrench on gas line fitting and one on regulator fitting.

5. Remove all screws securing range to cabinet or wall.
6. Slide range forward 5 inches in the cabinet.
7. Remove all control knobs-D.
8. Remove both aluminum gas lines-E to thermostat-F.
9. At rear wall of oven interior, just under flue opening, remove thermostat's capillary tube from tension clip.
10. Feed capillary tube through entry hole in oven's rear wall up into the burner box.
11. Remove the four screws holding manifold to burner box and remove manifold-G.
12. Remove bolts securing thermostat to manifold and remove thermostat -F.

#### INSTALLATION PROCEDURE-

1. Connect new thermostat to manifold, torque to 20-25 inch pounds.
2. Reinstall manifold to burner box.
3. Carefully feed capillary tube back into oven and replace in tension clip so that it is straight, horizontal and directly centered beneath the flue opening.

Note: If capillary tube becomes kinked or out of place it will not function properly. Any damage to capillary tube requires replacing whole thermostat. Individual parts of thermostat cannot be repaired or replaced.

4. Continue reassembling range by following the **REMOVAL PROCEDURES** in reverse order.
5. After reconnecting both aluminum gas supply lines to manifold, replace all top burners and/or burner tubes.
6. Check all connections for gas leaks using a non-corrosive leak detection fluid. Do not use a soap and water solution. Leak testing in excess of 14 inches water column (1/2 psi) of air pressure will invalidate warranty.
7. To verify safety valve connection is properly seated and will not leak:
  - a. Remove oven heat shield (if supplied), bottom oven shelf and rack.
  - b. Turn gas supply on.
  - c. Set oven control to 400°F.
  - d. Apply a non-corrosive leak detection fluid to safety valve gas input line connection and check for leaks.
  - e. When certain connection is properly sealed and will not leak, turn oven control to OFF.
  - f. If there are no leaks reinstall heat shield (if supplied), bottom oven shelf and rack.